

Bevel Back Weatherboard - 20mm Cavity on Flexible Underlay

Drawing	Sheet Name	Date
Typical Details		
RKB-C-00	Index V1	20.11.2014
RKB-C-BATT	RKB Battens	20.11.2014
RKFLG	Flashing Details	20.11.2014
RKB-C-MOULD	RKB Corner Profiles	20.11.2014
RKNAIL	RK Nails	20.11.2014
Window Details		
RKB-C-01	Aluminium Head Detail	20.11.2014
RKB-C-02	Aluminium Jamb Detail	20.11.2014
RKB-C-02a	Aluminium Jamb Detail Option	20.11.2014
RKB-C-03	Aluminium Sill Detail	20.11.2014
Internal Corner Details		
RKB-C-11	Internal Corner Detail - Option 1	20.11.2014
RKB-C-12	Internal Corner Detail - Option 2	20.11.2014
External Corner Details		
RKB-C-21	External Corner Detail - Option 1	20.11.2014
RKB-C-22	External Corner Detail - Option 2	20.11.2014
Horizontal Details		
RKB-C-31	Pipe Penetration Detail	20.11.2014
Vertical Details		
RKB-C-41	Bottom Plate Detail	20.11.2014
RKB-C-42	Top Plate to Soffit Detail	20.11.2014
RKB-C-43	Barge Detail	20.11.2014
RKB-C-44	Soffit Detail	20.11.2014
RKB-C-45	Parapet Detail	20.11.2014
RKB-C-46	Scarf Joint Detail	20.11.2014
RKB-C-47	Nail Fixing Detail	20.11.2014
RKB-C-49	Nail Fixing Detail	20.11.2014
Optional Details		
RKB-C-91	Aluminium Boxed Head Detail - Option	20.11.2014
RKB-C-92	Aluminium Boxed Jamb Detail - Option	20.11.2014
RKB-C-93	Aluminium Boxed Sill Detail - Option	20.11.2014
RKB-C-94	External Corner Detail - Option	20.11.2014



bevel back



CODEMARK™
CMA-CM40131



www.rosenfeldkidson.co.nz

Auckland Branch:
513 Mt Wellington Highway
Mt Wellington, Auckland 1060
T. +64 9 573 0503
F. +64 9 573 0504

Christchurch Branch:
15 Edmonton Road, Hornby
Christchurch 8042
T. +64 3 349 3316
F. +64 3 349 3317

Postal address: PO Box 621, Shortland Street, Auckland 1140

Title **Index V1**
Drawing **RKB-C-00**
Scale @ A4 Date 20.11.2014

1. Scope as per Clauses 1.0 and 9.4 E2/AS1
2. Profiles as per NZS 3617 Branz Bulletin 411
3. Fixings as per Table 24 E2/AS1
4. Compatibility of materials as per Tables 20-22 E2/AS1
5. Flashing as per Clause 4.0 E2/AS1
6. Rigid and flexible underlay as per Table 23 and Clauses 9.1.5 to 9.1.7 E2/AS1 or proprietary approved alternative
7. All weatherboards to be factory oiled to all faces and weathergrooves prior to installation
8. The weatherboard system relies on the joinery meeting the requirements of NZS 4211 for the relevant building windzone or wind pressure.

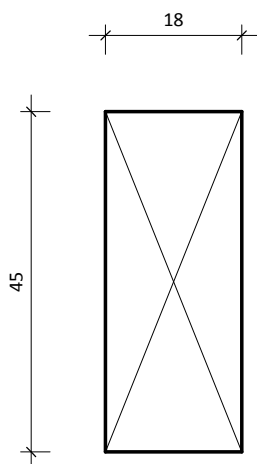

18x45mm Vertical timber cavity batten

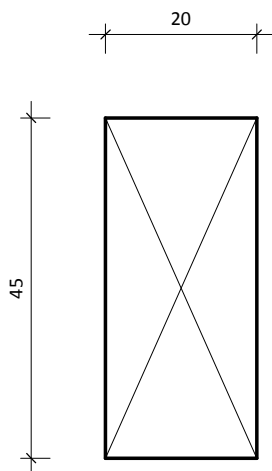

20x45mm Vertical timber cavity batten



bevel back



CODEMARKTM
CMA-CM40131



**Rosenfeld
Kidson**

www.rosenfeldkidson.co.nz

Auckland Branch:
513 Mt Wellington Highway
Mt Wellington, Auckland 1060
T. +64 9 573 0503
F. +64 9 573 0504

Christchurch Branch:
15 Edmonton Road, Hornby
Christchurch 8042
T. +64 3 349 3316
F. +64 3 349 3317

Postal address: PO Box 621, Shortland Street, Auckland 1140

Title **RKB Battens**

Drawing

RKB-C-BATT

Scale 1 : 1 @ A4

Date 20.11.2014

1. Scope as per Clauses 1.0 and 9.4 E2/AS1
2. Profiles as per NZS 3617 Branz Bulletin 411
3. Fixings as per Table 24 E2/AS1
4. Compatibility of materials as per Tables 20-22 E2/AS1
5. Flashing as per Clause 4.0 E2/AS1
6. Rigid and flexible underlay as per Table 23 and Clauses 9.1.5 to 9.1.7 E2/AS1 or proprietary approved alternative
7. All weatherboards to be factory oiled to all faces and weathergrooves prior to installation
8. The weatherboard system relies on the joinery meeting the requirements of NZS 4211 for the relevant building windzone or wind pressure.



bevel back



CODEMARKTM
CMA-CM40131

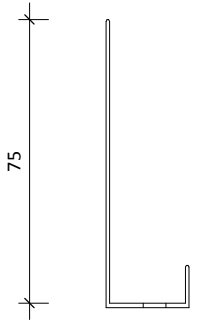

Cavity closer

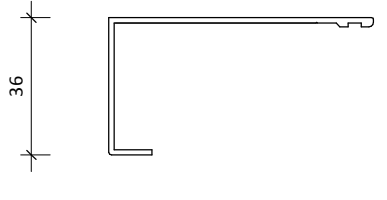

RKFL-15 powder coated aluminium jamb flashing.
Colour to suit joinery

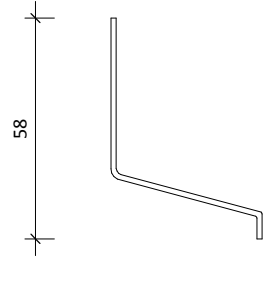

Cavity closer

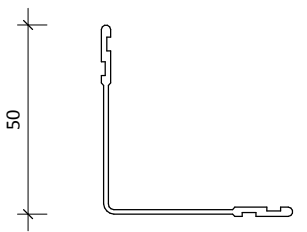

50x50mm internal/ external corner back flashing

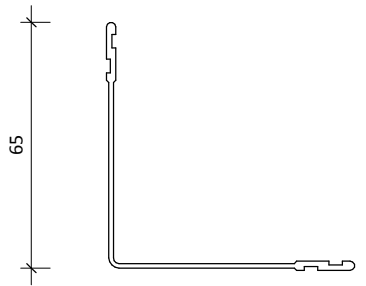

65x65mm internal/ external corner back flashing

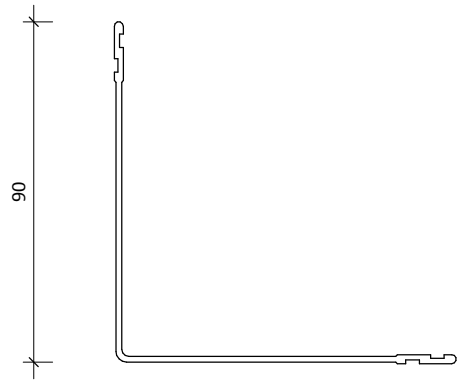

90x90mm internal/ external corner back flashing



www.rosenfeldkidson.co.nz

Auckland Branch:
513 Mt Wellington Highway
Mt Wellington, Auckland 1060
T. +64 9 573 0503
F. +64 9 573 0504

Christchurch Branch:
15 Edmonton Road, Hornby
Christchurch 8042
T. +64 3 349 3316
F. +64 3 349 3317

Postal address: PO Box 621, Shortland Street, Auckland 1140

Title **Flashing Details**

Drawing
RKFLG

Scale 1 : 2 @ A4 Date 20.11.2014

1. Scope as per Clauses 1.0 and 9.4 E2/AS1
2. Profiles as per NZS 3617 Branz Bulletin 411
3. Fixings as per Table 24 E2/AS1
4. Compatibility of materials as per Tables 20-22 E2/AS1
5. Flashing as per Clause 4.0 E2/AS1
6. Rigid and flexible underlay as per Table 23 and Clauses 9.1.5 to 9.1.7 E2/AS1 or proprietary approved alternative
7. All weatherboards to be factory oiled to all faces and weathergrooves prior to installation
8. The weatherboard system relies on the joinery meeting the requirements of NZS 4211 for the relevant building windzone or wind pressure.



bevel back



CODEMARKTM
CMA-CM40131

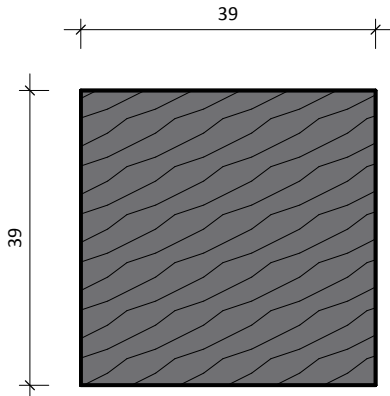

RK110 Internal timber moulding

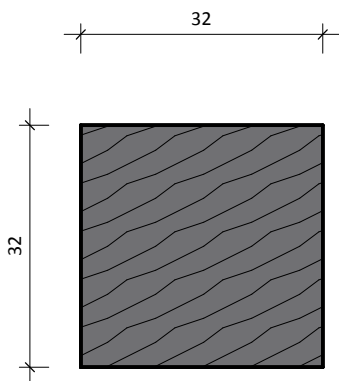

32x32mm Timber moulding

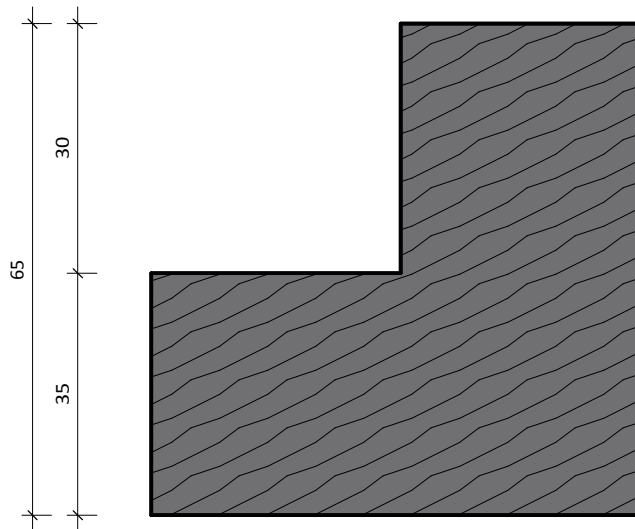

65x65x35mm External timber moulding



**Rosenfeld
Kidson**

www.rosenfeldkidson.co.nz

Auckland Branch:
513 Mt Wellington Highway
Mt Wellington, Auckland 1060
T. +64 9 573 0503
F. +64 9 573 0504

Christchurch Branch:
15 Edmonton Road, Hornby
Christchurch 8042
T. +64 3 349 3316
F. +64 3 349 3317

Postal address: PO Box 621, Shortland Street, Auckland 1140

Title **RKB Corner Profiles**

Drawing

RKB-C-MOULD

Scale 1 : 1 @ A4

Date 20.11.2014

1. Scope as per Clauses 1.0 and 9.4 E2/AS1
2. Profiles as per NZS 3617 Branz Bulletin 411
3. Fixings as per Table 24 E2/AS1
4. Compatibility of materials as per Tables 20-22 E2/AS1
5. Flashing as per Clause 4.0 E2/AS1
6. Rigid and flexible underlay as per Table 23 and Clauses 9.1.5 to 9.1.7 E2/AS1 or proprietary approved alternative
7. All weatherboards to be factory oiled to all faces and weathergrooves prior to installation
8. The weatherboard system relies on the joinery meeting the requirements of NZS 4211 for the relevant building windzone or wind pressure.

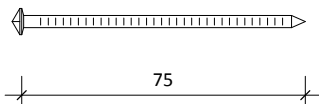

Direct fixed 75 x 3.15mm

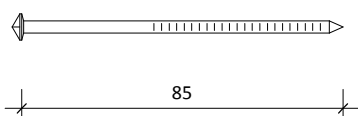

Cavity fixed 85 x 3.15mm

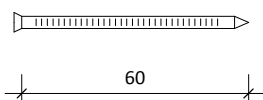

Direct fixed 60 x 3.30mm Stainless steel nail
Softhead nail for paint finish weatherboards.

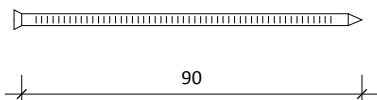

Cavity fixed 90 x 3.30mm Stainless steel nail
Jolthead nail for paint finish weatherboards.

RK Plug Nail Range

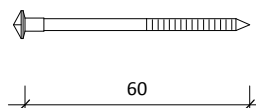

Cedarscreen Plug Nail 60 x 3.15mm

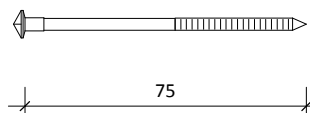

Cedarscreen Plug Nail 75 x 3.15mm

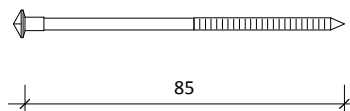

Cedarscreen Plug Nail 85 x 3.15mm

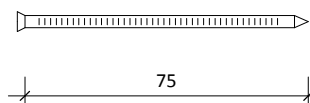

Cavity fixed 75 x 3.30mm Stainless steel nail
Jolthead nail for paint finish weatherboards.

Options:

- Silicon bronze annular groove
- Stainless steel 316 grade annular groove



**Rosenfeld
Kidson**

www.rosenfeldkidson.co.nz

Auckland Branch:
513 Mt Wellington Highway
Mt Wellington, Auckland 1060
T. +64 9 573 0503
F. +64 9 573 0504

Christchurch Branch:
15 Edmonton Road, Hornby
Christchurch 8042
T. +64 3 349 3316
F. +64 3 349 3317

Postal address: PO Box 621, Shortland Street, Auckland 1140

Title **RK Nails**

Drawing

RKNAIL

Scale 1 : 2 @ A4

Date 20.11.2014

1. Scope as per Clauses 1.0 and 9.4 E2/AS1
2. Profiles as per NZS 3617 Branz Bulletin 411
3. Fixings as per Table 24 E2/AS1
4. Compatibility of materials as per Tables 20-22 E2/AS1
5. Flashing as per Clause 4.0 E2/AS1
6. Rigid and flexible underlay as per Table 23 and Clauses 9.1.5 to 9.1.7 E2/AS1 or proprietary approved alternative
7. All weatherboards to be factory oiled to all faces and weathergrooves prior to installation
8. The weatherboard system relies on the joinery meeting the requirements of NZS 4211 for the relevant building windzone or wind pressure.



bevel back



CODEMARK™
CMA-CM40131

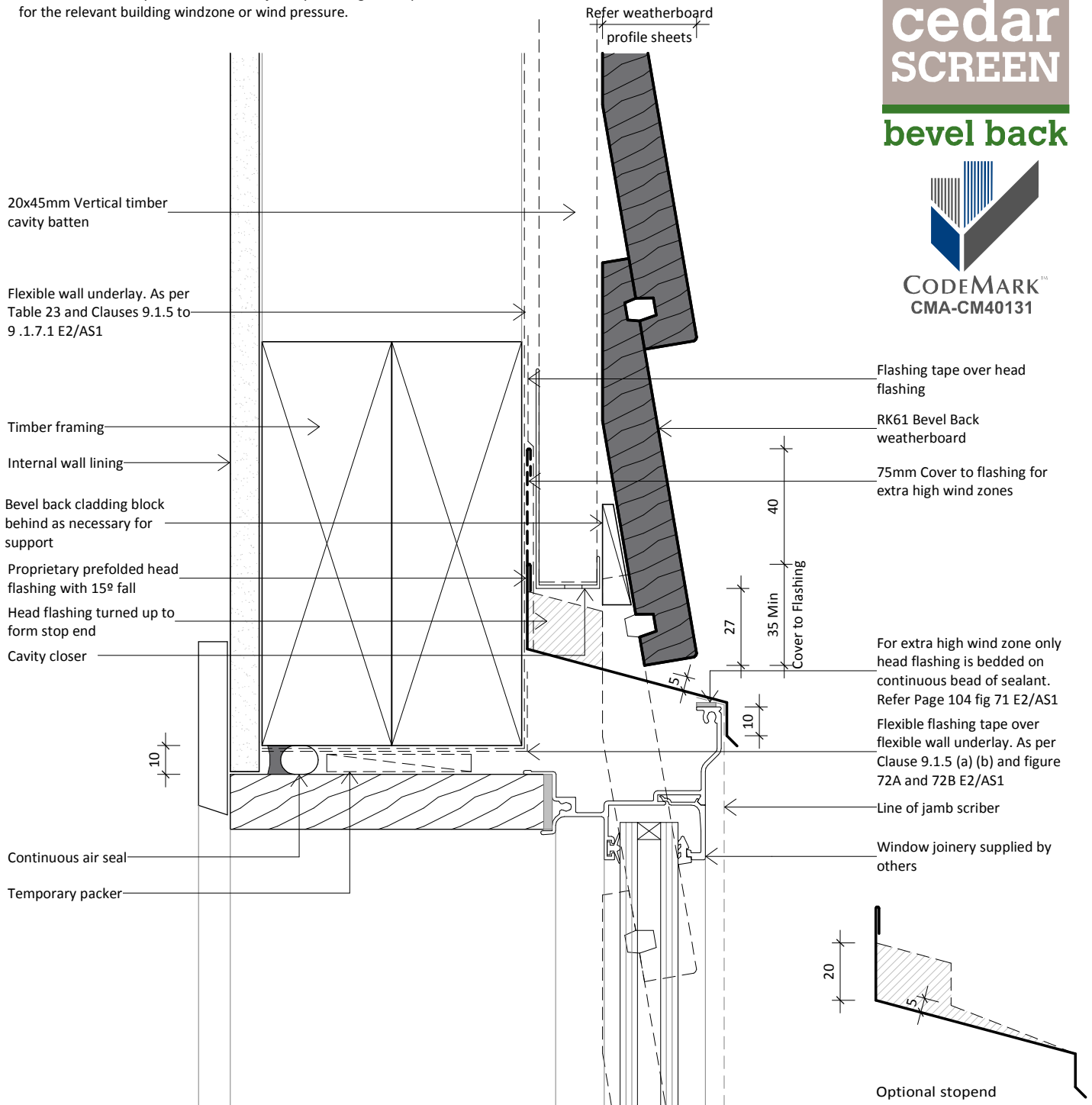

www.rosenfeldkidson.co.nz

Auckland Branch:
513 Mt Wellington Highway
Mt Wellington, Auckland 1060
T. +64 9 573 0503
F. +64 9 573 0504

Christchurch Branch:
15 Edmonton Road, Hornby
Christchurch 8042
T. +64 3 349 3316
F. +64 3 349 3317

Postal address: PO Box 621, Shortland Street, Auckland 1140

Title **Aluminium Head Detail**

Drawing **RKB-C-01**

Scale 1 : 2 @ A4 Date 20.11.2014

1. Scope as per Clauses 1.0 and 9.4 E2/AS1
2. Profiles as per NZS 3617 Branz Bulletin 411
3. Fixings as per Table 24 E2/AS1
4. Compatibility of materials as per Tables 20-22 E2/AS1
5. Flashing as per Clause 4.0 E2/AS1
6. Rigid and flexible underlay as per Table 23 and Clauses 9.1.5 to 9.1.7 E2/AS1 or proprietary approved alternative
7. All weatherboards to be factory oiled to all faces and weathergrooves prior to installation
8. The weatherboard system relies on the joinery meeting the requirements of NZS 4211 for the relevant building windzone or wind pressure.



bevel back



CODEMARK™
CMA-CM40131

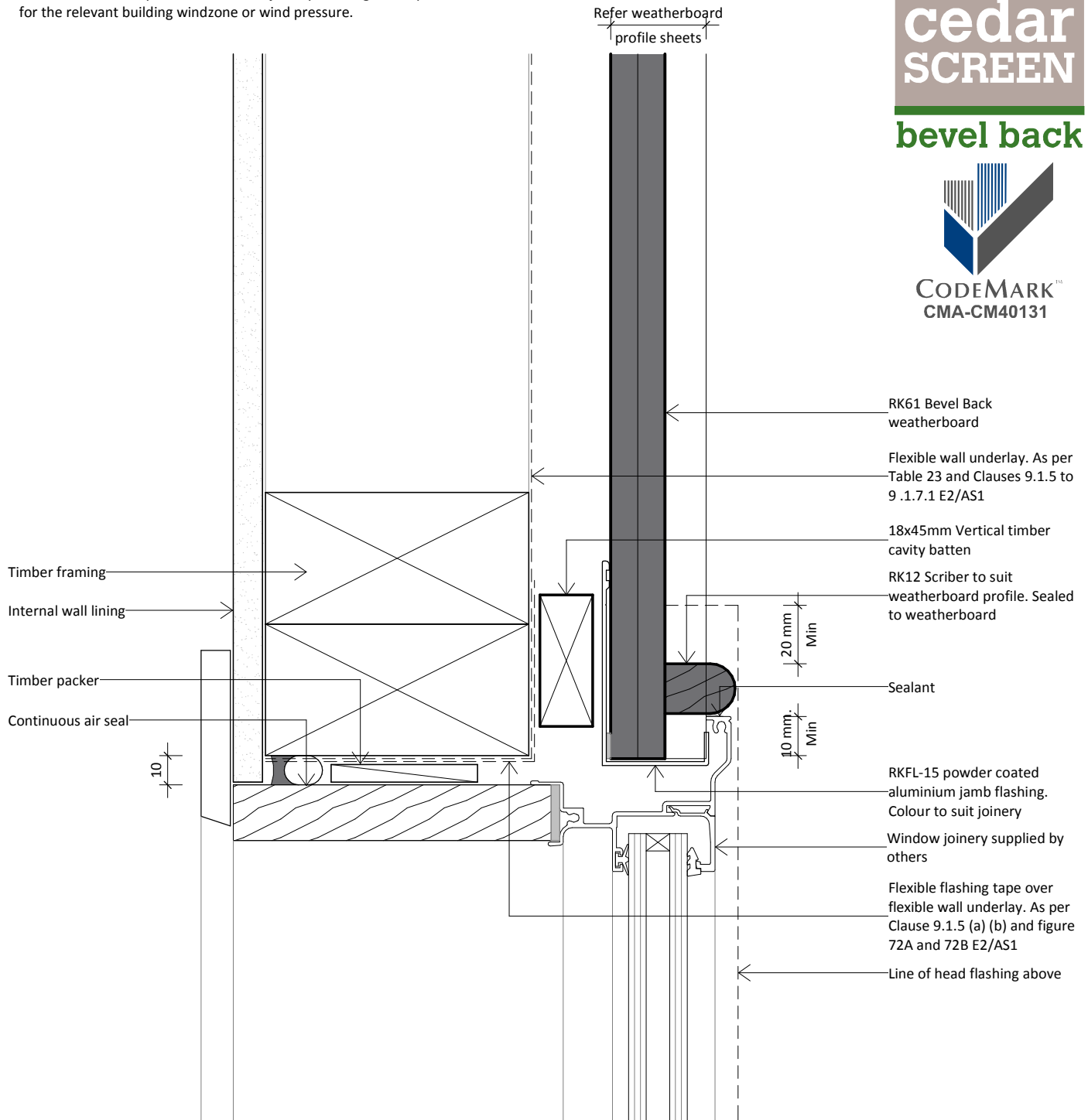

**Rosenfeld
Kidson**

www.rosenfeldkidson.co.nz

Auckland Branch:
513 Mt Wellington Highway
Mt Wellington, Auckland 1060
T. +64 9 573 0503
F. +64 9 573 0504

Christchurch Branch:
15 Edmonton Road, Hornby
Christchurch 8042
T. +64 3 349 3316
F. +64 3 349 3317

Postal address: PO Box 621, Shortland Street, Auckland 1140

Title **Aluminium Jamb Detail**

Drawing

RKB-C-02

Scale 1 : 2 @ A4

Date 20.11.2014

1. Scope as per Clauses 1.0 and 9.4 E2/AS1
2. Profiles as per NZS 3617 Branz Bulletin 411
3. Fixings as per Table 24 E2/AS1
4. Compatibility of materials as per Tables 20-22 E2/AS1
5. Flashing as per Clause 4.0 E2/AS1
6. Rigid and flexible underlay as per Table 23 and Clauses 9.1.5 to 9.1.7 E2/AS1 or proprietary approved alternative
7. All weatherboards to be factory oiled to all faces and weathergrooves prior to installation
8. The weatherboard system relies on the joinery meeting the requirements of NZS 4211 for the relevant building windzone or wind pressure.



bevel back



CODEMARK™
CMA-CM40131

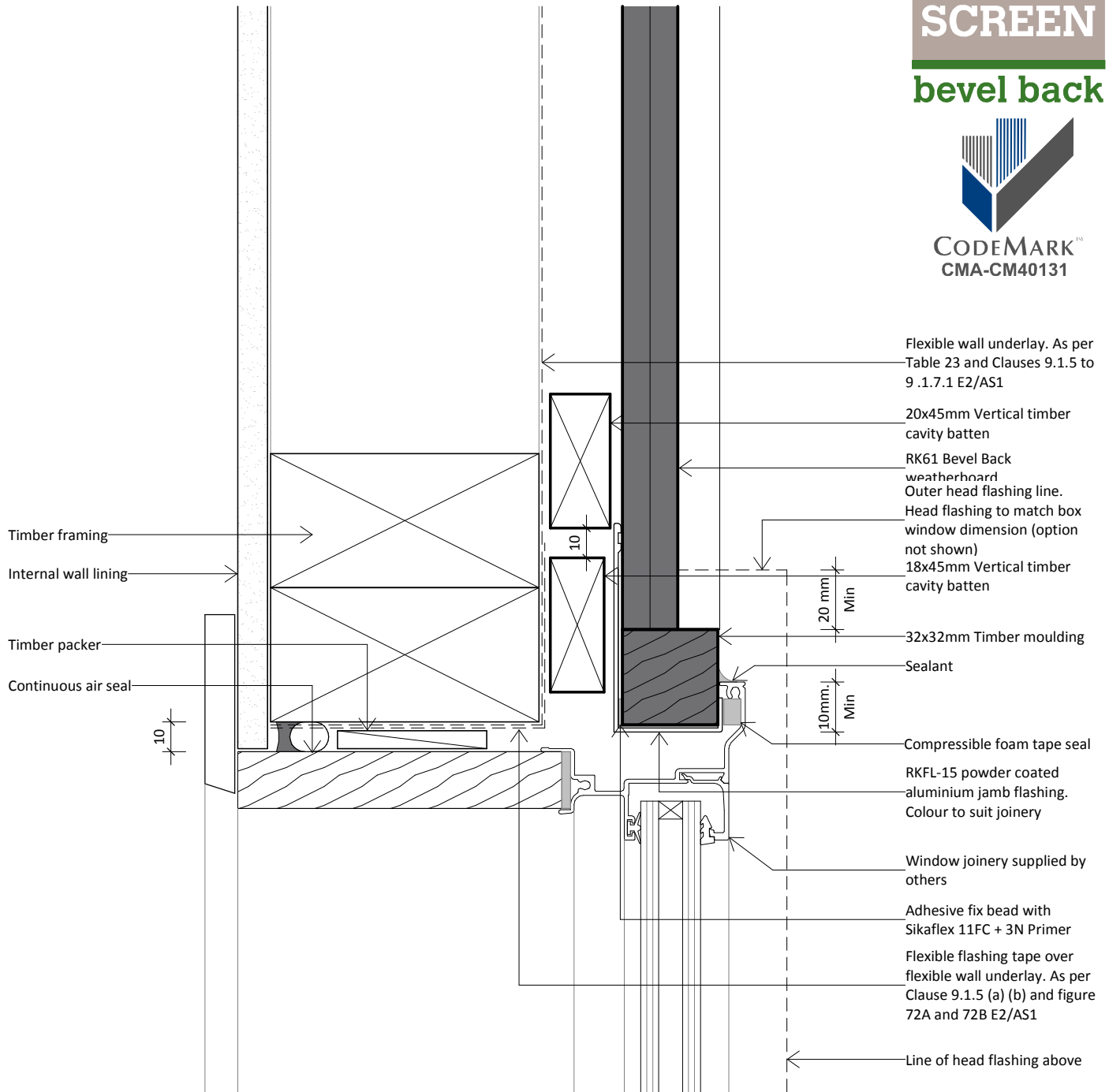

www.rosenfeldkidson.co.nz

Auckland Branch:
513 Mt Wellington Highway
Mt Wellington, Auckland 1060
T. +64 9 573 0503
F. +64 9 573 0504

Christchurch Branch:
15 Edmonton Road, Hornby
Christchurch 8042
T. +64 3 349 3316
F. +64 3 349 3317

Postal address: PO Box 621, Shortland Street, Auckland 1140

Title **Aluminium Jamb Detail Option**

Drawing **RKB-C-02a**

Scale 1 : 2 @ A4 Date 20.11.2014

1. Scope as per Clauses 1.0 and 9.4 E2/AS1
2. Profiles as per NZS 3617 Branz Bulletin 411
3. Fixings as per Table 24 E2/AS1
4. Compatibility of materials as per Tables 20-22 E2/AS1
5. Flashing as per Clause 4.0 E2/AS1
6. Rigid and flexible underlay as per Table 23 and Clauses 9.1.5 to 9.1.7 E2/AS1 or proprietary approved alternative
7. All weatherboards to be factory oiled to all faces and weathergrooves prior to installation
8. The weatherboard system relies on the joinery meeting the requirements of NZS 4211 for the relevant building windzone or wind pressure.



bevel back



CODEMARK™
CMA-CM40131

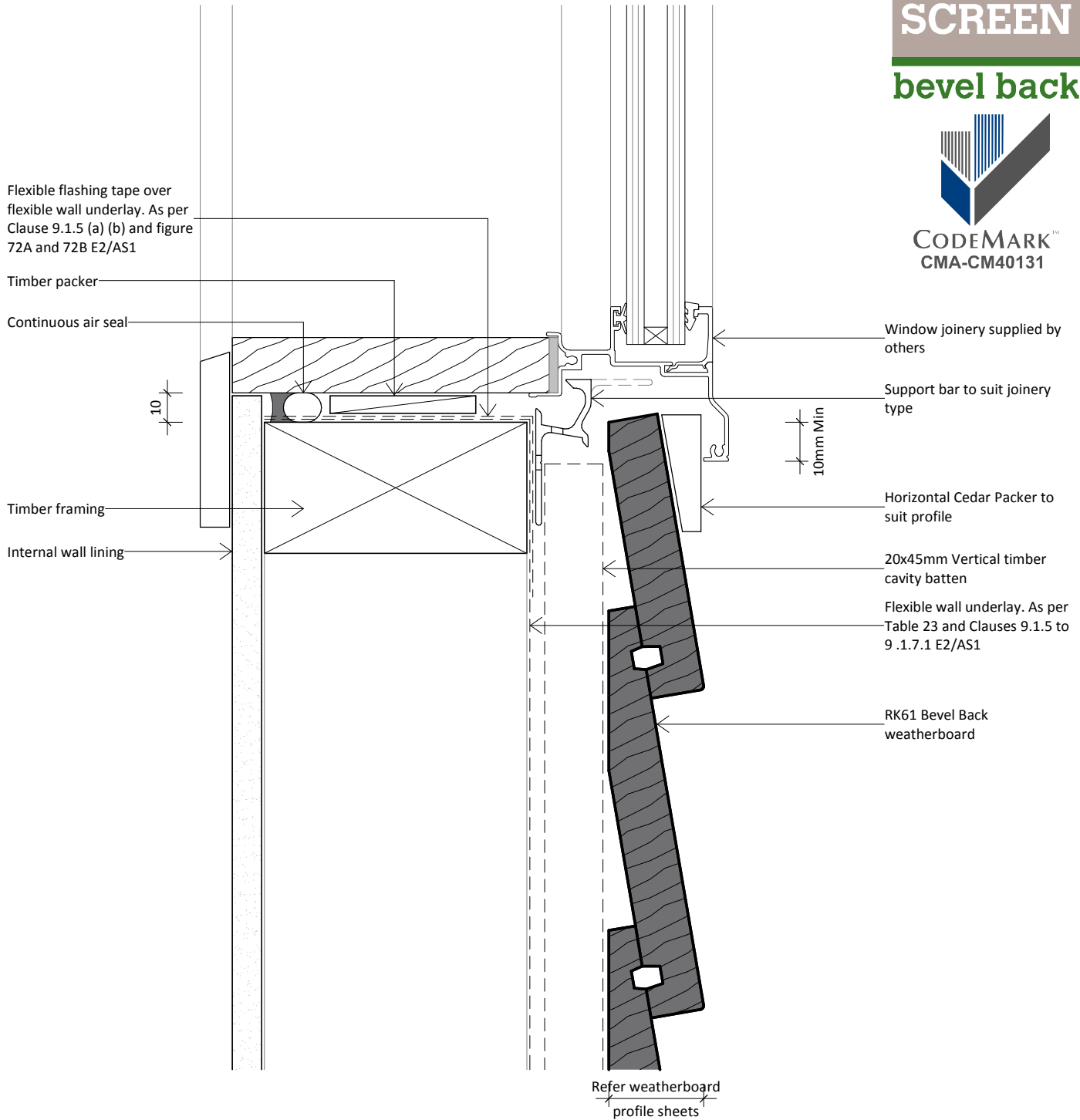

**Rosenfeld
Kidson**

www.rosenfeldkidson.co.nz

Auckland Branch:
513 Mt Wellington Highway
Mt Wellington, Auckland 1060
T. +64 9 573 0503
F. +64 9 573 0504

Christchurch Branch:
15 Edmonton Road, Hornby
Christchurch 8042
T. +64 3 349 3316
F. +64 3 349 3317

Postal address: PO Box 621, Shortland Street, Auckland 1140

Title **Aluminium Sill Detail**

Drawing

RKB-C-03

Scale 1 : 2 @ A4

Date 20.11.2014

1. Scope as per Clauses 1.0 and 9.4 E2/AS1
2. Profiles as per NZS 3617 Branz Bulletin 411
3. Fixings as per Table 24 E2/AS1
4. Compatibility of materials as per Tables 20-22 E2/AS1
5. Flashing as per Clause 4.0 E2/AS1
6. Rigid and flexible underlay as per Table 23 and Clauses 9.1.5 to 9.1.7 E2/AS1 or proprietary approved alternative
7. All weatherboards to be factory oiled to all faces and weathergrooves prior to installation
8. The weatherboard system relies on the joinery meeting the requirements of NZS 4211 for the relevant building windzone or wind pressure.



bevel back



CODEMARK™
CMA-CM40131

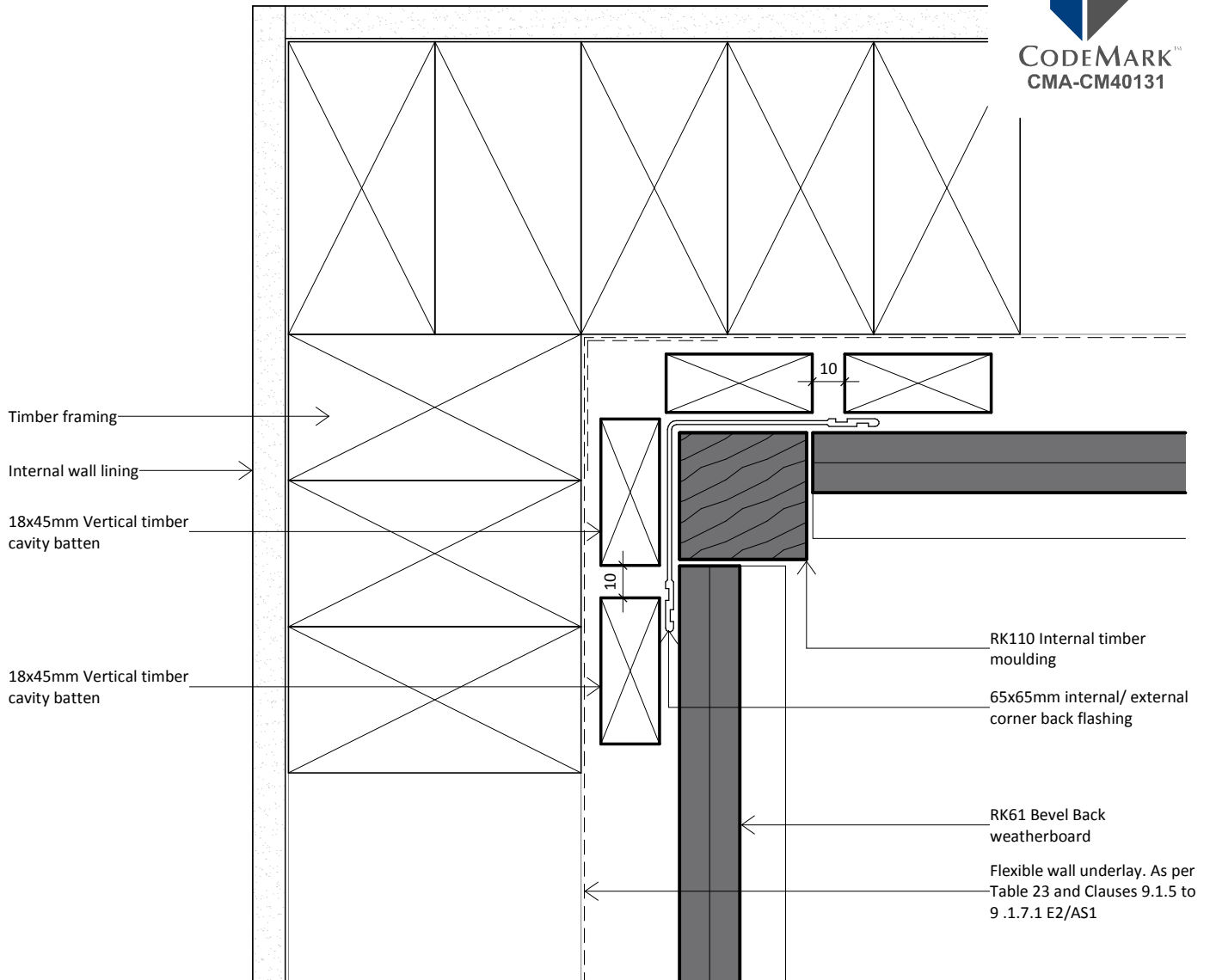

**Rosenfeld
Kidson**

www.rosenfeldkidson.co.nz

Auckland Branch:
513 Mt Wellington Highway
Mt Wellington, Auckland 1060
T. +64 9 573 0503
F. +64 9 573 0504

Christchurch Branch:
15 Edmonton Road, Hornby
Christchurch 8042
T. +64 3 349 3316
F. +64 3 349 3317

Postal address: PO Box 621, Shortland Street, Auckland 1140

Title **Internal Corner Detail - Option 1**

Drawing

RKB-C-11

Scale 1 : 2 @ A4

Date 20.11.2014

1. Scope as per Clauses 1.0 and 9.4 E2/AS1
2. Profiles as per NZS 3617 Branz Bulletin 411
3. Fixings as per Table 24 E2/AS1
4. Compatibility of materials as per Tables 20-22 E2/AS1
5. Flashing as per Clause 4.0 E2/AS1
6. Rigid and flexible underlay as per Table 23 and Clauses 9.1.5 to 9.1.7 E2/AS1 or proprietary approved alternative
7. All weatherboards to be factory oiled to all faces and weathergrooves prior to installation
8. The weatherboard system relies on the joinery meeting the requirements of NZS 4211 for the relevant building windzone or wind pressure.



bevel back



CODEMARK™
CMA-CM40131

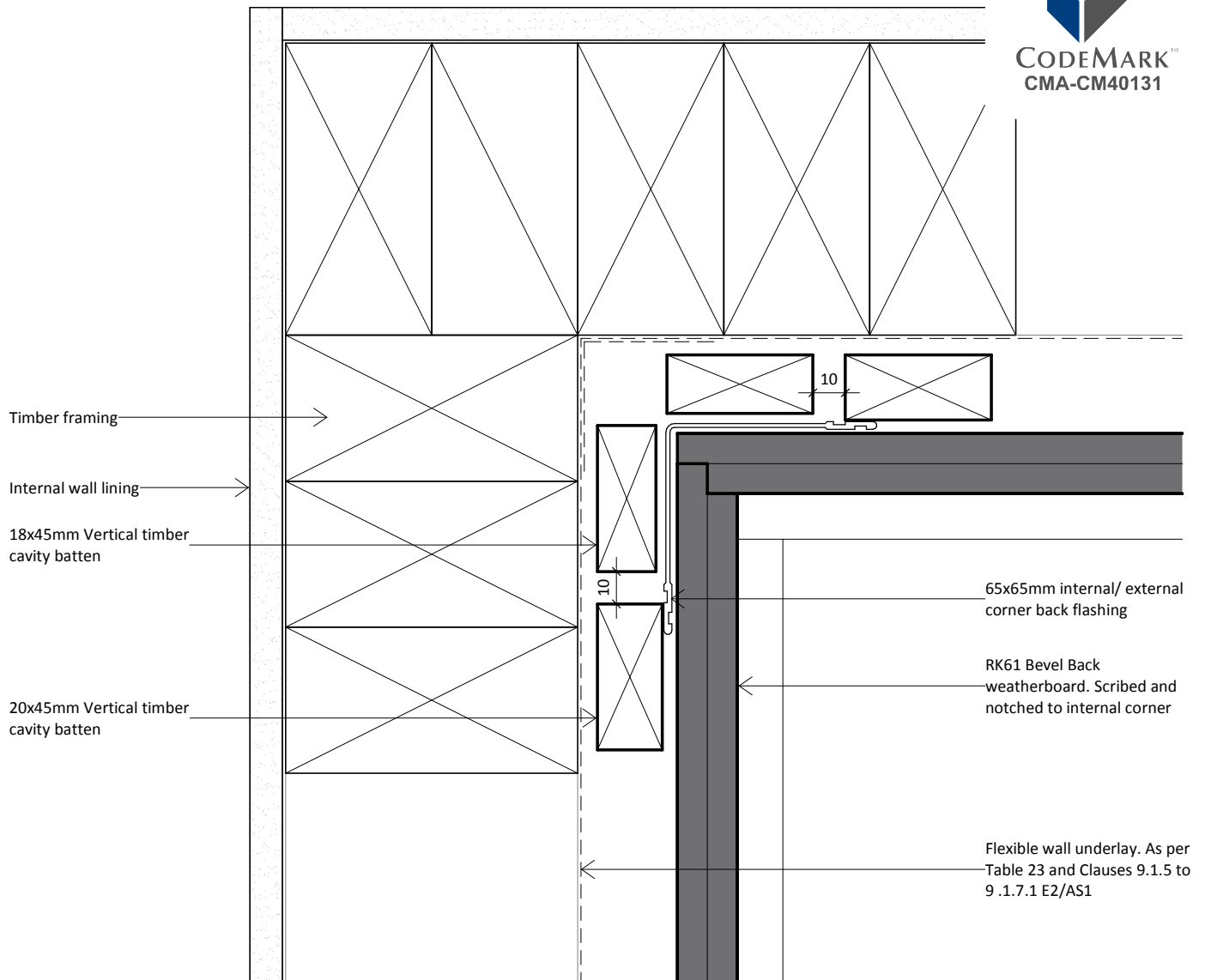

**Rosenfeld
Kidson**

www.rosenfeldkidson.co.nz

Auckland Branch:
513 Mt Wellington Highway
Mt Wellington, Auckland 1060
T. +64 9 573 0503
F. +64 9 573 0504

Christchurch Branch:
15 Edmonton Road, Hornby
Christchurch 8042
T. +64 3 349 3316
F. +64 3 349 3317

Postal address: PO Box 621, Shortland Street, Auckland 1140

Title **Internal Corner Detail - Option 2**

Drawing

RKB-C-12

Scale 1 : 2 @ A4

Date 20.11.2014

1. Scope as per Clauses 1.0 and 9.4 E2/AS1
2. Profiles as per NZS 3617 Branz Bulletin 411
3. Fixings as per Table 24 E2/AS1
4. Compatibility of materials as per Tables 20-22 E2/AS1
5. Flashing as per Clause 4.0 E2/AS1
6. Rigid and flexible underlay as per Table 23 and Clauses 9.1.5 to 9.1.7 E2/AS1 or proprietary approved alternative
7. All weatherboards to be factory oiled to all faces and weathergrooves prior to installation
8. The weatherboard system relies on the joinery meeting the requirements of NZS 4211 for the relevant building windzone or wind pressure.



bevel back



CODEMARK™
CMA-CM40131

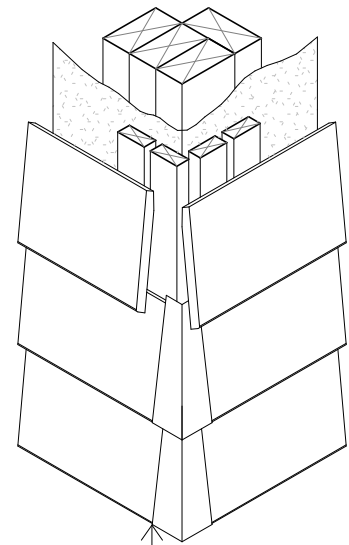

Corrosive resistant corner soaker

18x45mm Vertical timber cavity batten

50x50mm internal/ external corner back flashing

Corrosive resistant corner soaker

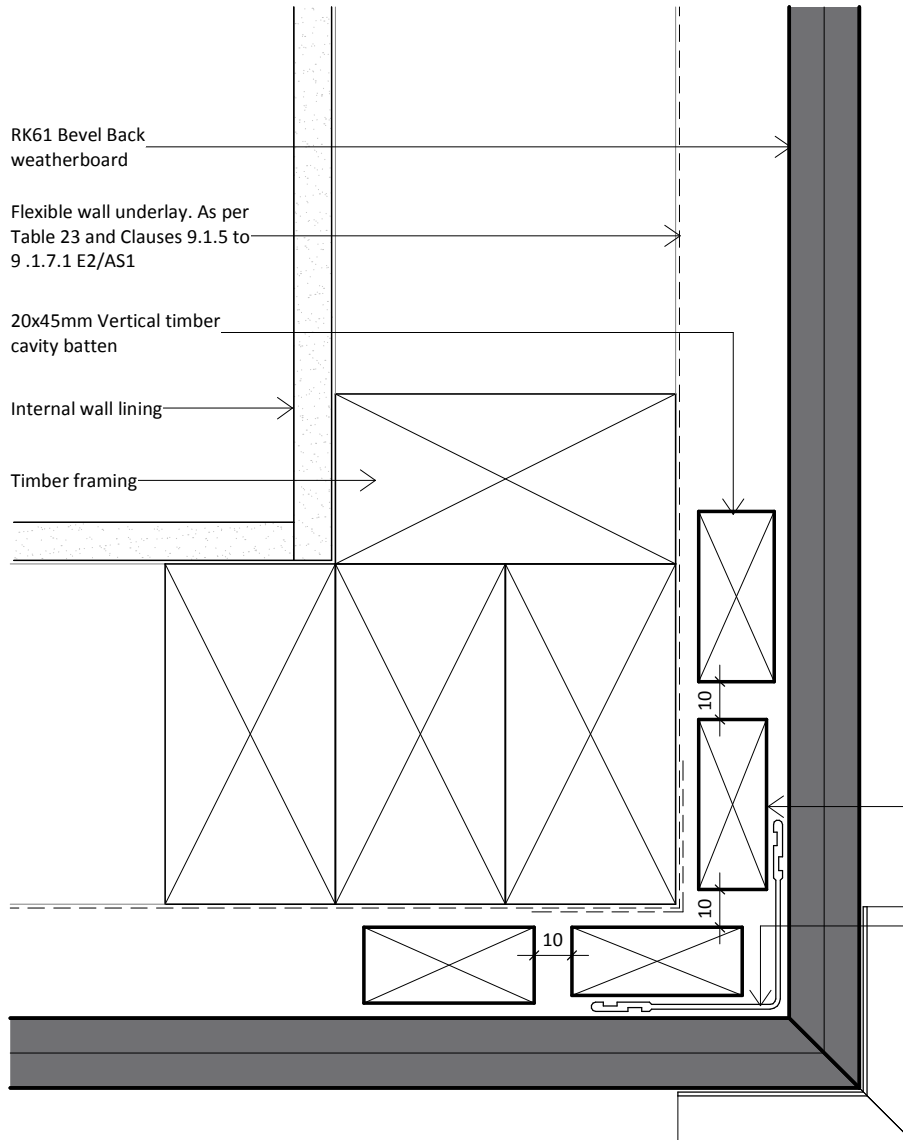

Rosenfeld Kidson

www.rosenfeldkidson.co.nz

<p>Auckland Branch: 513 Mt Wellington Highway Mt Wellington, Auckland 1060 T. +64 9 573 0503 F. +64 9 573 0504</p>	<p>Christchurch Branch: 15 Edmonton Road, Hornby Christchurch 8042 T. +64 3 349 3316 F. +64 3 349 3317</p>
<p>Postal address: PO Box 621, Shortland Street, Auckland 1140</p>	

<p>Title External Corner Detail - Option 1</p> <p>Drawing RKB-C-21</p> <p>Scale 1 : 2 @ A4</p>	<p>Date 20.11.2014</p>
--	----------------------------

1. Scope as per Clauses 1.0 and 9.4 E2/AS1
2. Profiles as per NZS 3617 Branz Bulletin 411
3. Fixings as per Table 24 E2/AS1
4. Compatibility of materials as per Tables 20-22 E2/AS1
5. Flashing as per Clause 4.0 E2/AS1
6. Rigid and flexible underlay as per Table 23 and Clauses 9.1.5 to 9.1.7 E2/AS1 or proprietary approved alternative
7. All weatherboards to be factory oiled to all faces and weathergrooves prior to installation
8. The weatherboard system relies on the joinery meeting the requirements of NZS 4211 for the relevant building windzone or wind pressure.



bevel back



CODEMARK™
CMA-CM40131

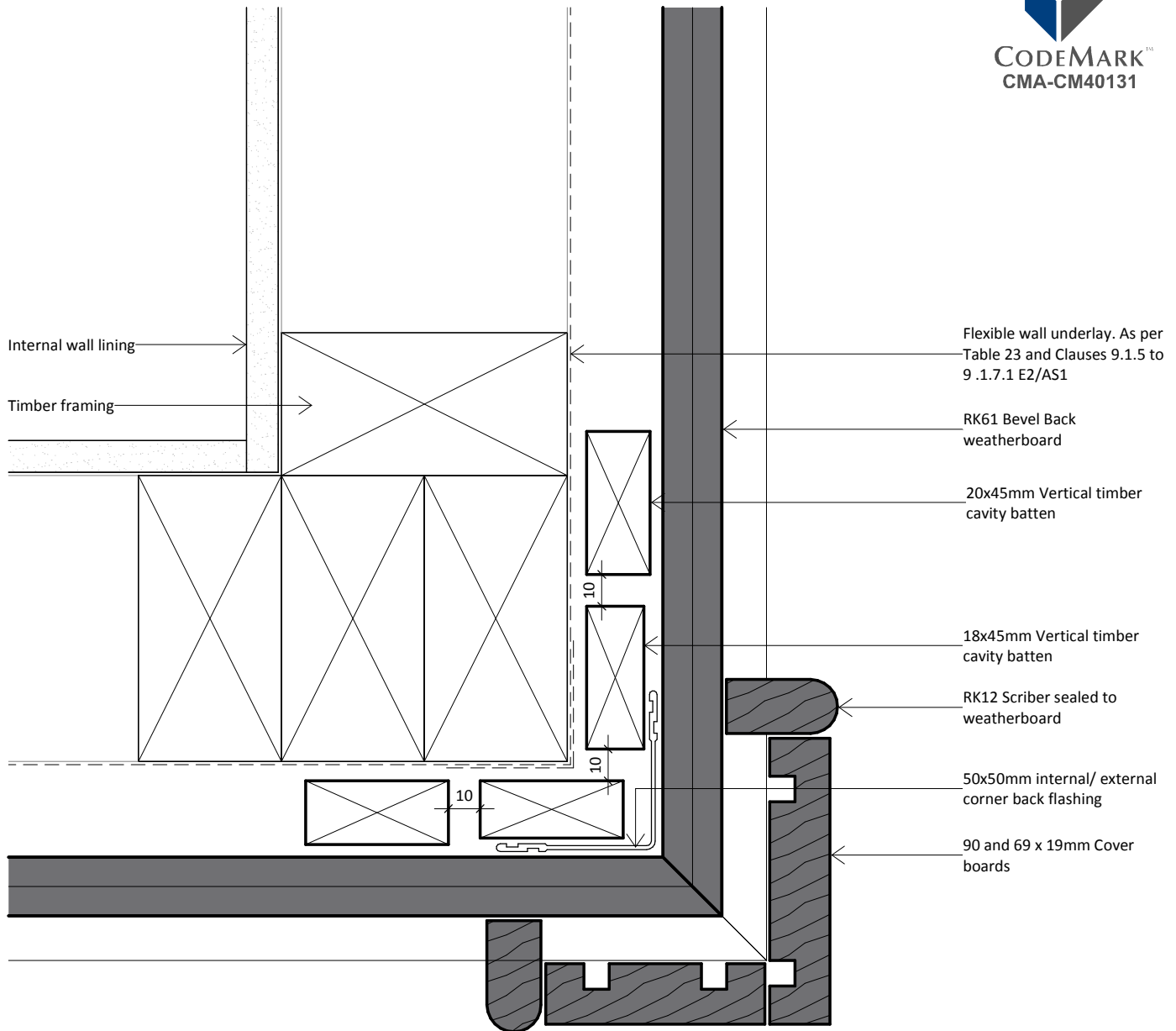

**Rosenfeld
Kidson**

www.rosenfeldkidson.co.nz

Auckland Branch:
513 Mt Wellington Highway
Mt Wellington, Auckland 1060
T. +64 9 573 0503
F. +64 9 573 0504

Christchurch Branch:
15 Edmonton Road, Hornby
Christchurch 8042
T. +64 3 349 3316
F. +64 3 349 3317

Postal address: PO Box 621, Shortland Street, Auckland 1140

Title **External Corner Detail - Option 2**

Drawing **RKB-C-22**

Scale 1 : 2 @ A4 Date 20.11.2014

1. Scope as per Clauses 1.0 and 9.4 E2/AS1
2. Profiles as per NZS 3617 Branz Bulletin 411
3. Fixings as per Table 24 E2/AS1
4. Compatibility of materials as per Tables 20-22 E2/AS1
5. Flashing as per Clause 4.0 E2/AS1
6. Rigid and flexible underlay as per Table 23 and Clauses 9.1.5 to 9.1.7 E2/AS1 or proprietary approved alternative
7. All weatherboards to be factory oiled to all faces and weathergrooves prior to installation
8. The weatherboard system relies on the joinery meeting the requirements of NZS 4211 for the relevant building windzone or wind pressure.



bevel back



CODEMARK™
CMA-CM40131

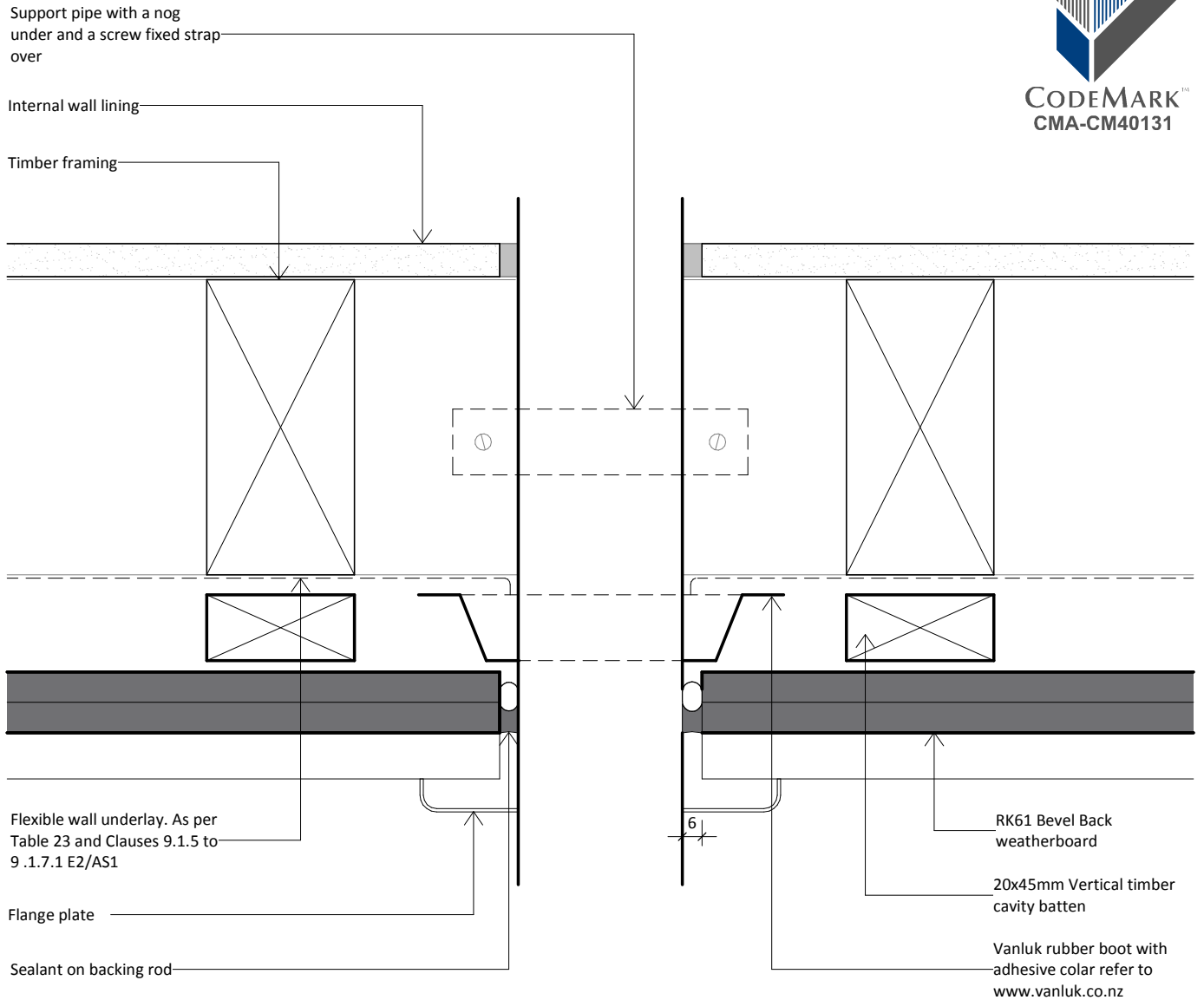

**Rosenfeld
Kidson**

www.rosenfeldkidson.co.nz

Auckland Branch:
513 Mt Wellington Highway
Mt Wellington, Auckland 1060
T. +64 9 573 0503
F. +64 9 573 0504

Christchurch Branch:
15 Edmonton Road, Hornby
Christchurch 8042
T. +64 3 349 3316
F. +64 3 349 3317

Postal address: PO Box 621, Shortland Street, Auckland 1140

Title **Pipe Penetration Detail**

Drawing
RKB-C-31

Scale 1 : 2 @ A4 Date 20.11.2014

1. Scope as per Clauses 1.0 and 9.4 E2/AS1
2. Profiles as per NZS 3617 Branz Bulletin 411
3. Fixings as per Table 24 E2/AS1
4. Compatibility of materials as per Tables 20-22 E2/AS1
5. Flashing as per Clause 4.0 E2/AS1
6. Rigid and flexible underlay as per Table 23 and Clauses 9.1.5 to 9.1.7 E2/AS1 or proprietary approved alternative
7. All weatherboards to be factory oiled to all faces and weathergrooves prior to installation
8. The weatherboard system relies on the joinery meeting the requirements of NZS 4211 for the relevant building windzone or wind pressure.



bevel back



CODEMARK™
CMA-CM40131

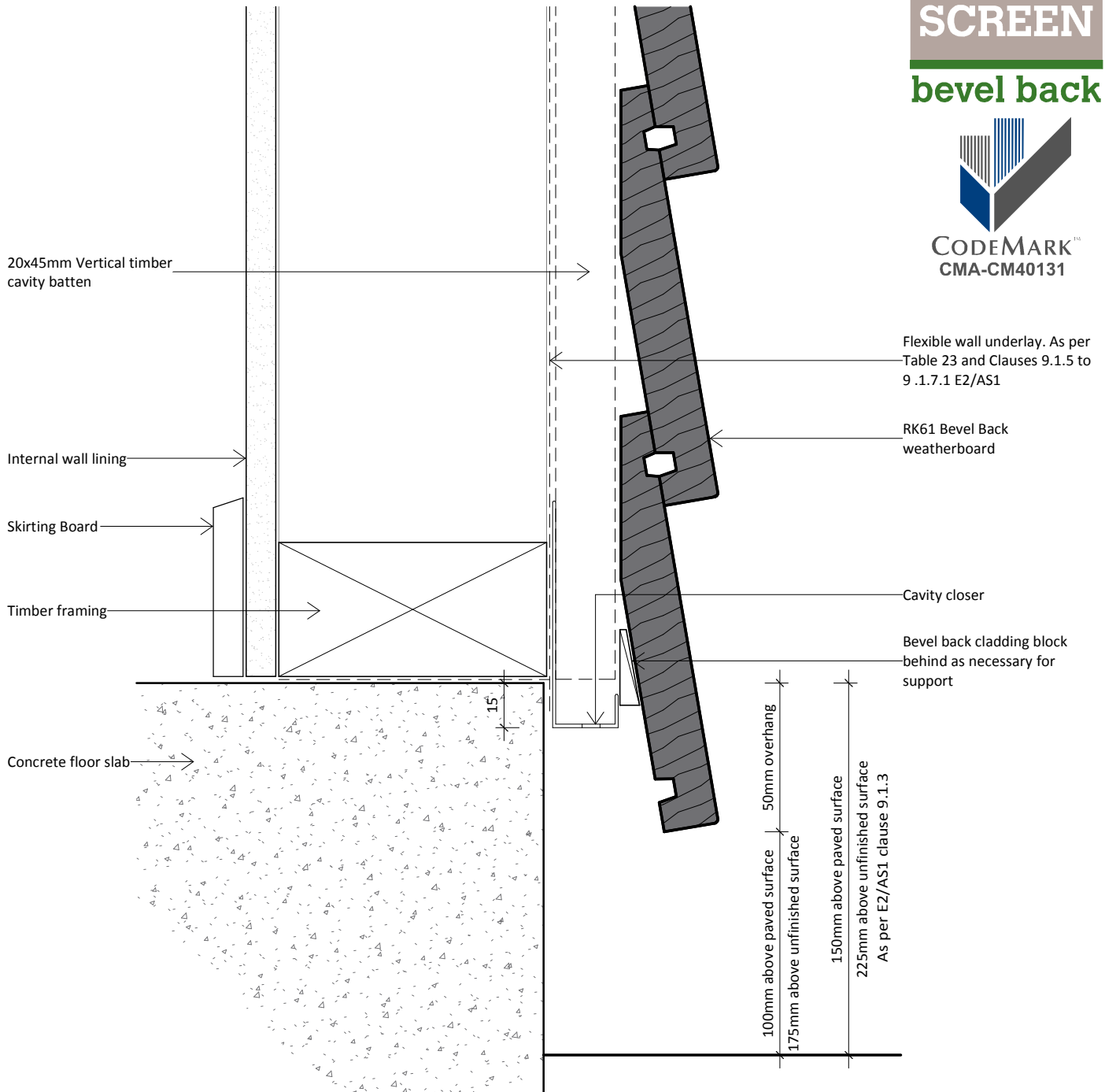

**Rosenfeld
Kidson**

www.rosenfeldkidson.co.nz

Auckland Branch:
513 Mt Wellington Highway
Mt Wellington, Auckland 1060
T. +64 9 573 0503
F. +64 9 573 0504

Christchurch Branch:
15 Edmonton Road, Hornby
Christchurch 8042
T. +64 3 349 3316
F. +64 3 349 3317

Postal address: PO Box 621, Shortland Street, Auckland 1140

Title **Bottom Plate Detail**

Drawing

RKB-C-41

Scale 1 : 2 @ A4

Date 20.11.2014

1. Scope as per Clauses 1.0 and 9.4 E2/AS1
2. Profiles as per NZS 3617 Branz Bulletin 411
3. Fixings as per Table 24 E2/AS1
4. Compatibility of materials as per Tables 20-22 E2/AS1
5. Flashing as per Clause 4.0 E2/AS1
6. Rigid and flexible underlay as per Table 23 and Clauses 9.1.5 to 9.1.7 E2/AS1 or proprietary approved alternative
7. All weatherboards to be factory oiled to all faces and weathergrooves prior to installation
8. The weatherboard system relies on the joinery meeting the requirements of NZS 4211 for the relevant building windzone or wind pressure.



bevel back



CODEMARK™
CMA-CM40131

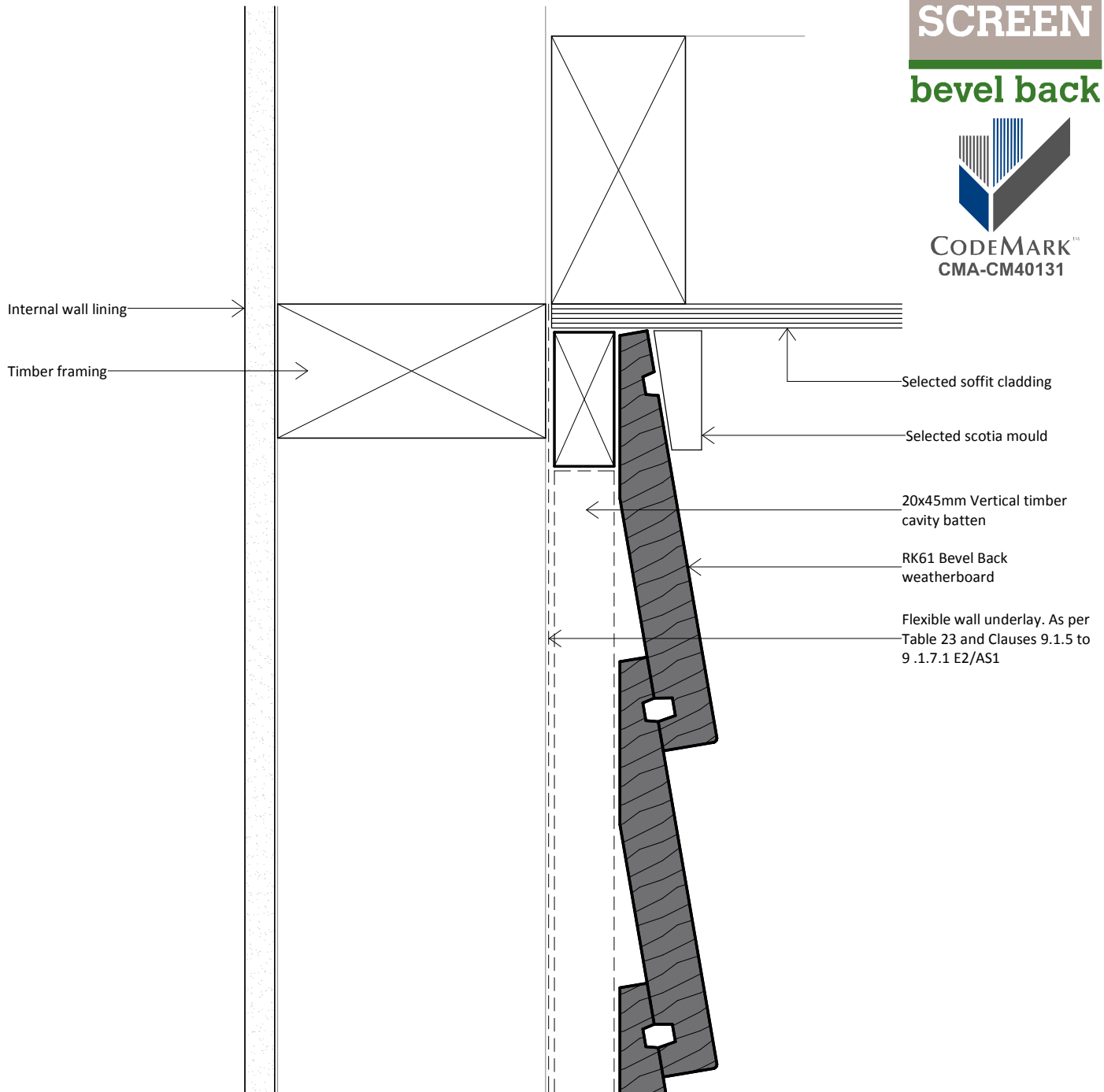

**Rosenfeld
Kidson**

www.rosenfeldkidson.co.nz

Auckland Branch:
513 Mt Wellington Highway
Mt Wellington, Auckland 1060
T. +64 9 573 0503
F. +64 9 573 0504

Christchurch Branch:
15 Edmonton Road, Hornby
Christchurch 8042
T. +64 3 349 3316
F. +64 3 349 3317

Postal address: PO Box 621, Shortland Street, Auckland 1140

Title **Top Plate to Soffit Detail**

Drawing

RKB-C-42

Scale 1 : 2 @ A4

Date 20.11.2014

1. Scope as per Clauses 1.0 and 9.4 E2/AS1
2. Profiles as per NZS 3617 Branz Bulletin 411
3. Fixings as per Table 24 E2/AS1
4. Compatibility of materials as per Tables 20-22 E2/AS1
5. Flashing as per Clause 4.0 E2/AS1
6. Rigid and flexible underlay as per Table 23 and Clauses 9.1.5 to 9.1.7 E2/AS1 or proprietary approved alternative
7. All weatherboards to be factory oiled to all faces and weathergrooves prior to installation
8. The weatherboard system relies on the joinery meeting the requirements of NZS 4211 for the relevant building windzone or wind pressure.



bevel back



CODEMARK
CMA-CM40131

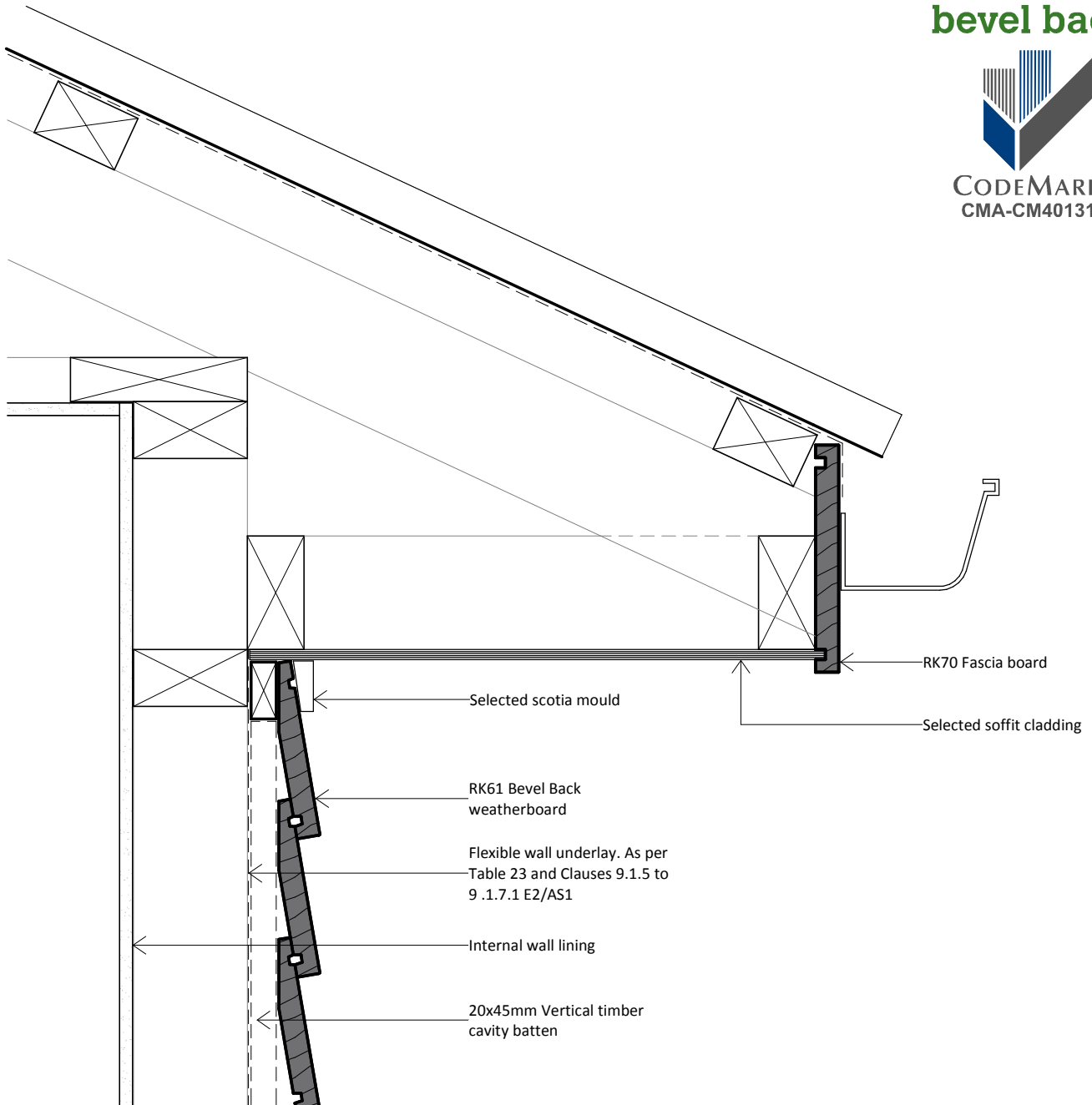

**Rosenfeld
Kidson**

www.rosenfeldkidson.co.nz

Auckland Branch:
513 Mt Wellington Highway
Mt Wellington, Auckland 1060
T. +64 9 573 0503
F. +64 9 573 0504

Christchurch Branch:
15 Edmonton Road, Hornby
Christchurch 8042
T. +64 3 349 3316
F. +64 3 349 3317

Postal address: PO Box 621, Shortland Street, Auckland 1140

Title **Barge Detail**

Drawing

RKB-C-43

Scale 1 : 5 @ A4

Date 20.11.2014

1. Scope as per Clauses 1.0 and 9.4 E2/AS1
2. Profiles as per NZS 3617 Branz Bulletin 411
3. Fixings as per Table 24 E2/AS1
4. Compatibility of materials as per Tables 20-22 E2/AS1
5. Flashing as per Clause 4.0 E2/AS1
6. Rigid and flexible underlay as per Table 23 and Clauses 9.1.5 to 9.1.7 E2/AS1 or proprietary approved alternative
7. All weatherboards to be factory oiled to all faces and weathergrooves prior to installation
8. The weatherboard system relies on the joinery meeting the requirements of NZS 4211 for the relevant building windzone or wind pressure.



bevel back



CODEMARK™
CMA-CM40131

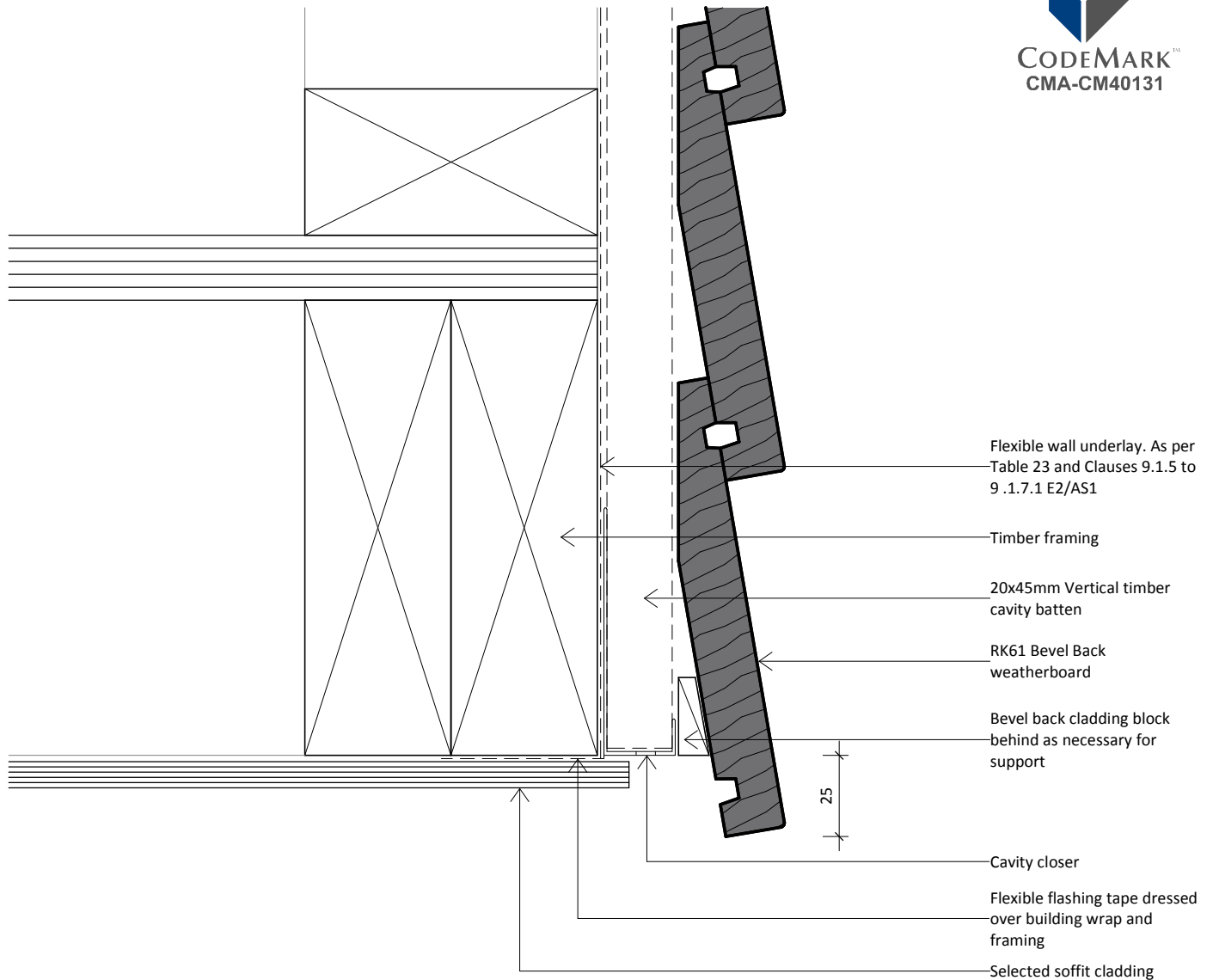

**Rosenfeld
Kidson**

www.rosenfeldkidson.co.nz

Auckland Branch:
513 Mt Wellington Highway
Mt Wellington, Auckland 1060
T. +64 9 573 0503
F. +64 9 573 0504

Christchurch Branch:
15 Edmonton Road, Hornby
Christchurch 8042
T. +64 3 349 3316
F. +64 3 349 3317

Postal address: PO Box 621, Shortland Street, Auckland 1140

Title **Soffit Detail**

Drawing

RKB-C-44

Scale 1 : 2 @ A4

Date 20.11.2014

1. Scope as per Clauses 1.0 and 9.4 E2/AS1
2. Profiles as per NZS 3617 Branz Bulletin 411
3. Fixings as per Table 24 E2/AS1
4. Compatibility of materials as per Tables 20-22 E2/AS1
5. Flashing as per Clause 4.0 E2/AS1
6. Rigid and flexible underlay as per Table 23 and Clauses 9.1.5 to 9.1.7 E2/AS1 or proprietary approved alternative
7. All weatherboards to be factory oiled to all faces and weathergrooves prior to installation
8. The weatherboard system relies on the joinery meeting the requirements of NZS 4211 for the relevant building windzone or wind pressure.



bevel back



CODEMARK™
CMA-CM40131

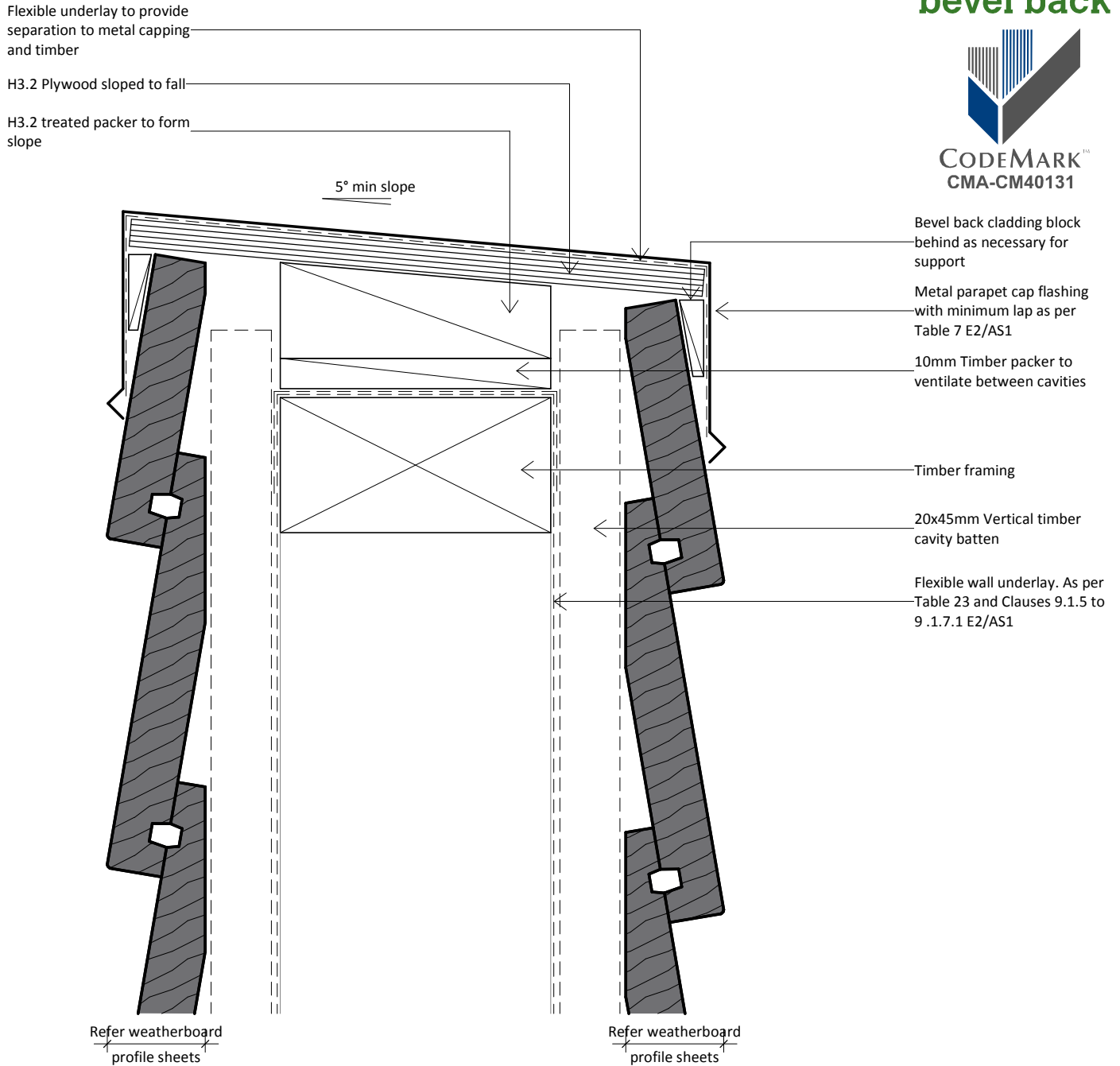

**Rosenfeld
Kidson**

www.rosenfeldkidson.co.nz

Auckland Branch:
513 Mt Wellington Highway
Mt Wellington, Auckland 1060
T. +64 9 573 0503
F. +64 9 573 0504

Christchurch Branch:
15 Edmonton Road, Hornby
Christchurch 8042
T. +64 3 349 3316
F. +64 3 349 3317

Postal address: PO Box 621, Shortland Street, Auckland 1140

Title **Parapet Detail**

Drawing

RKB-C-45

Scale 1 : 2 @ A4

Date 20.11.2014

1. Scope as per Clauses 1.0 and 9.4 E2/AS1
2. Profiles as per NZS 3617 Branz Bulletin 411
3. Fixings as per Table 24 E2/AS1
4. Compatibility of materials as per Tables 20-22 E2/AS1
5. Flashing as per Clause 4.0 E2/AS1
6. Rigid and flexible underlay as per Table 23 and Clauses 9.1.5 to 9.1.7 E2/AS1 or proprietary approved alternative
7. All weatherboards to be factory oiled to all faces and weathergrooves prior to installation
8. The weatherboard system relies on the joinery meeting the requirements of NZS 4211 for the relevant building windzone or wind pressure.



bevel back



CODEMARK
CMA-CM40131

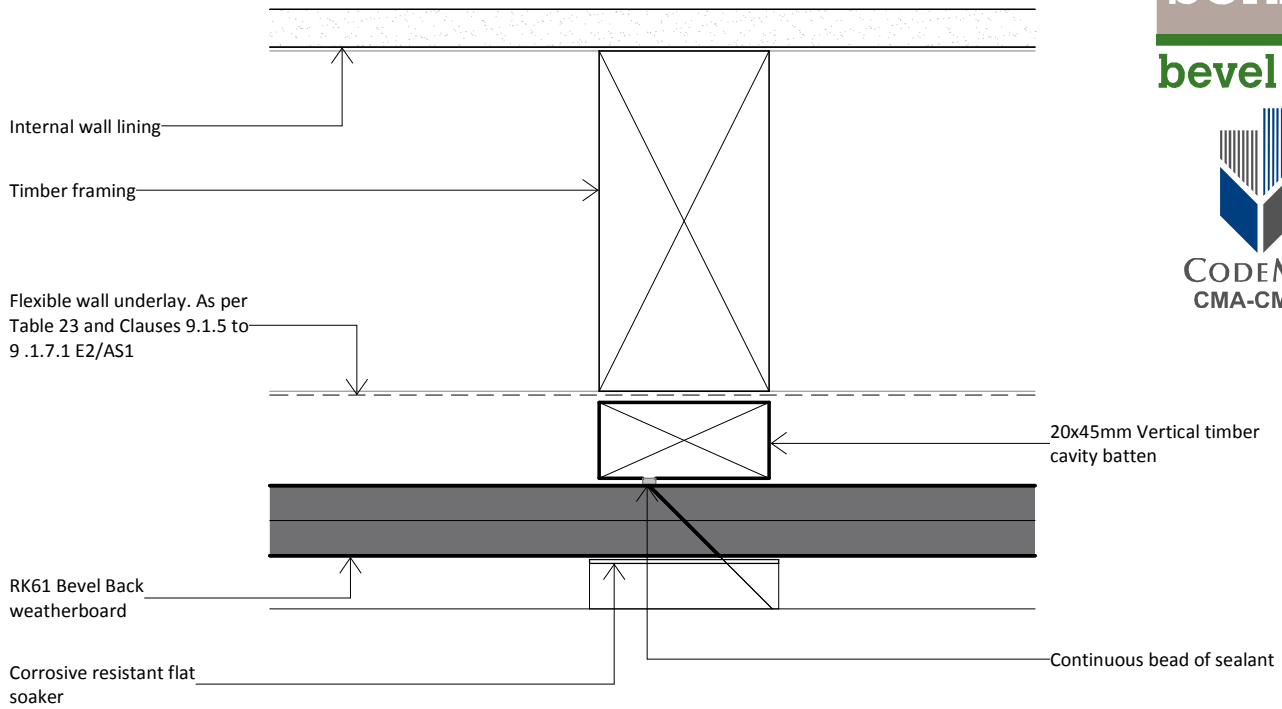

Horizontal Plan

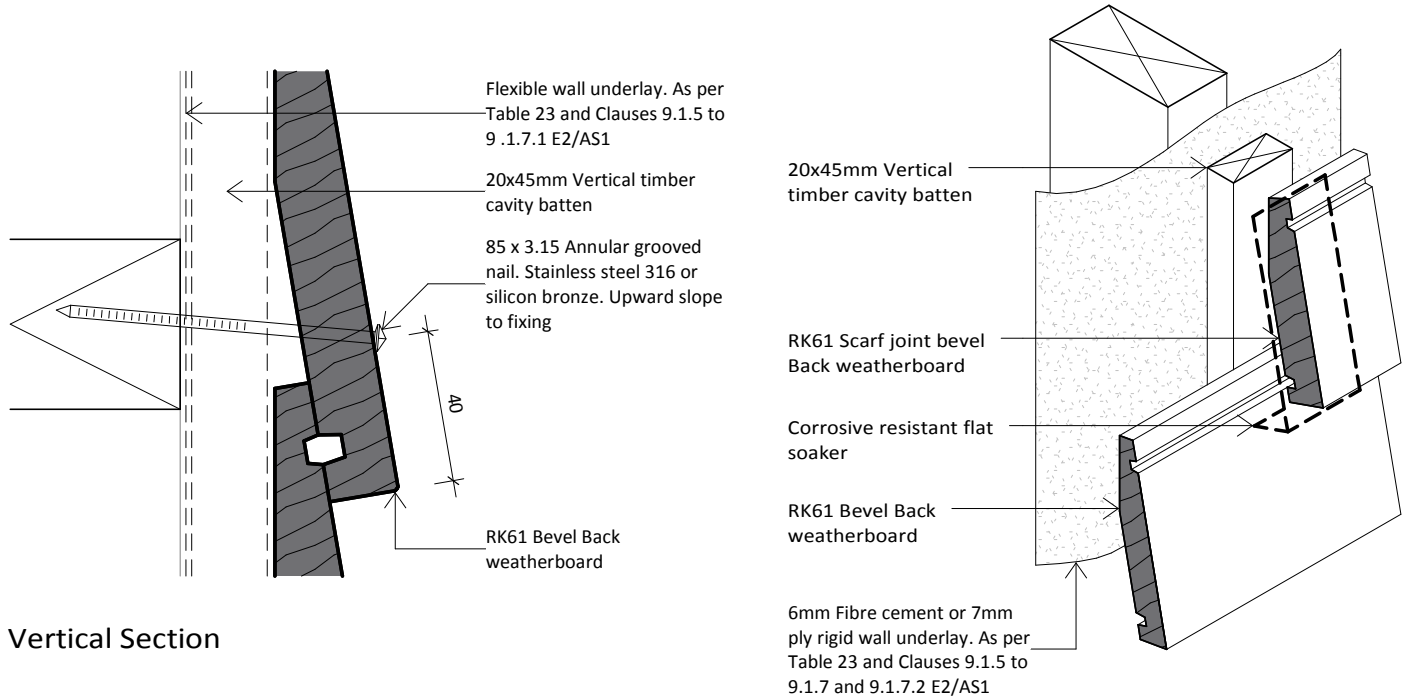

Vertical Section

<p>Rosenfeld Kidson</p> <p>www.rosenfeldkidson.co.nz</p>	<p>Auckland Branch:</p> <p>513 Mt Wellington Highway Mt Wellington, Auckland 1060 T. +64 9 573 0503 F. +64 9 573 0504</p>	<p>Christchurch Branch:</p> <p>15 Edmonton Road, Hornby Christchurch 8042 T. +64 3 349 3316 F. +64 3 349 3317</p>	<p>Title Scarf Joint Detail</p> <p>Drawing RKB-C-46</p> <p>Scale 1 : 2 @ A4 Date 20.11.2014</p>
	<p>Postal address: PO Box 621, Shortland Street, Auckland 1140</p>		

1. Scope as per Clauses 1.0 and 9.4 E2/AS1
2. Profiles as per NZS 3617 Branz Bulletin 411
3. Fixings as per Table 24 E2/AS1
4. Compatibility of materials as per Tables 20-22 E2/AS1
5. Flashing as per Clause 4.0 E2/AS1
6. Rigid and flexible underlay as per Table 23 and Clauses 9.1.5 to 9.1.7 E2/AS1 or proprietary approved alternative
7. All weatherboards to be factory oiled to all faces and weathergrooves prior to installation
8. The weatherboard system relies on the joinery meeting the requirements of NZS 4211 for the relevant building windzone or wind pressure.



bevel back



CODEMARK™
CMA-CM40131

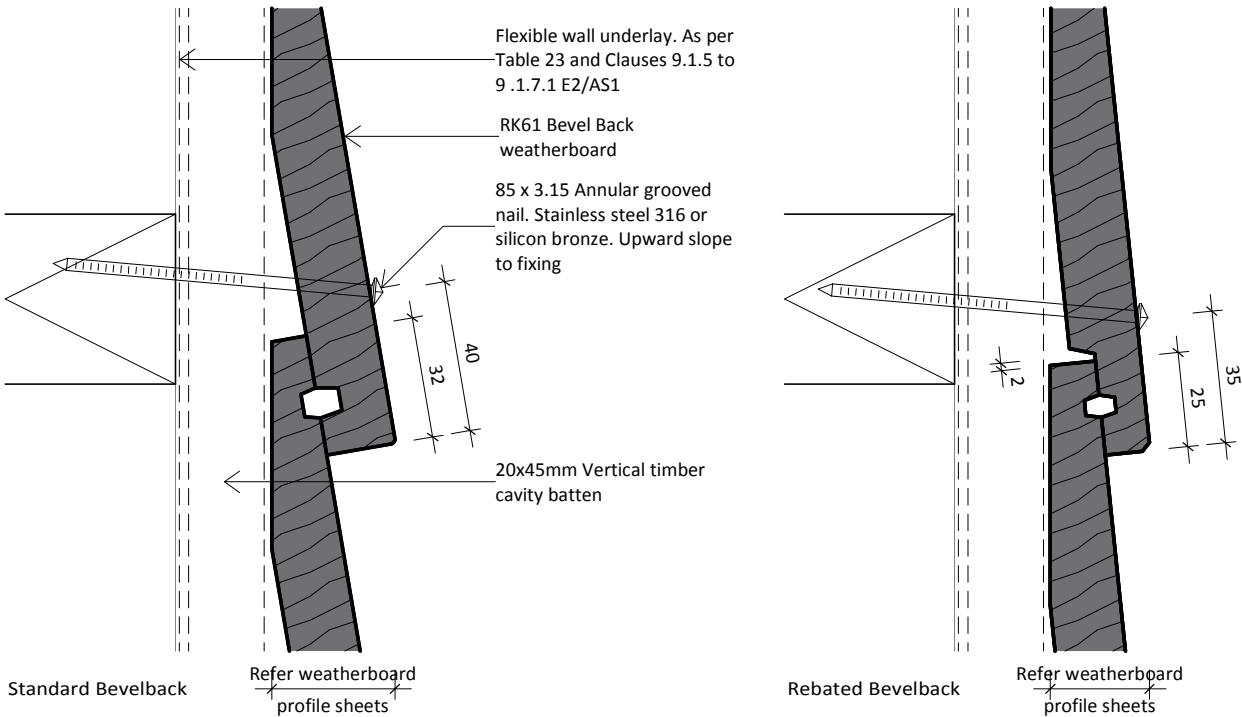
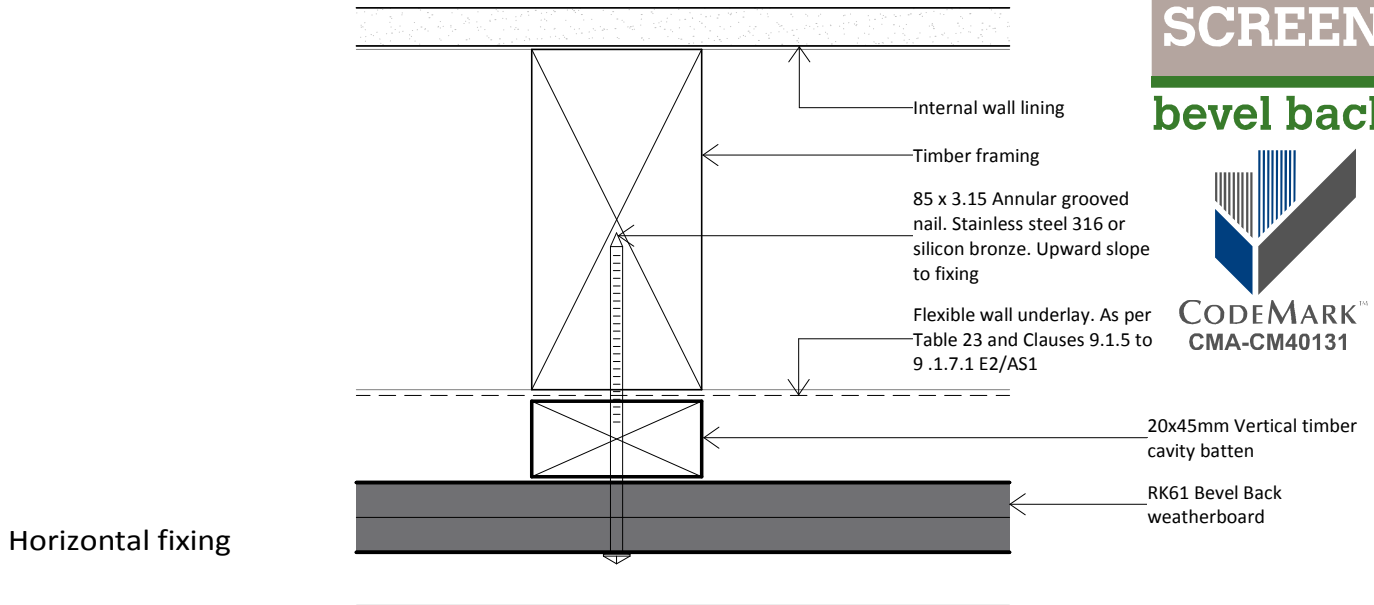

Vertical fixing



www.rosenfeldkidson.co.nz

Auckland Branch:
513 Mt Wellington Highway
Mt Wellington, Auckland 1060
T. +64 9 573 0503
F. +64 9 573 0504

Christchurch Branch:
15 Edmonton Road, Hornby
Christchurch 8042
T. +64 3 349 3316
F. +64 3 349 3317

Postal address: PO Box 621, Shortland Street, Auckland 1140

Title **Nail Fixing Detail**

Drawing

RKB-C-47

Scale 1 : 2 @ A4

Date 20.11.2014

1. Scope as per Clauses 1.0 and 9.4 E2/AS1
2. Profiles as per NZS 3617 Branz Bulletin 411
3. Fixings as per Table 24 E2/AS1
4. Compatibility of materials as per Tables 20-22 E2/AS1
5. Flashing as per Clause 4.0 E2/AS1
6. Rigid and flexible underlay as per Table 23 and Clauses 9.1.5 to 9.1.7 E2/AS1 or proprietary approved alternative
7. All weatherboards to be factory oiled to all faces and weathergrooves prior to installation
8. The weatherboard system relies on the joinery meeting the requirements of NZS 4211 for the relevant building windzone or wind pressure.



bevel back



CODEMARK™
CMA-CM40131

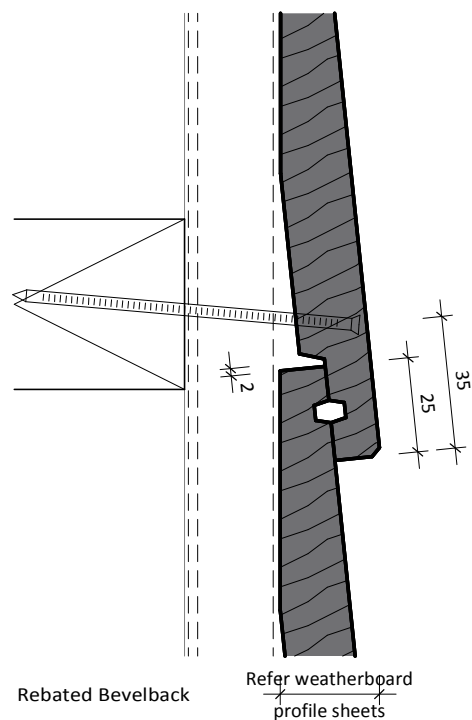
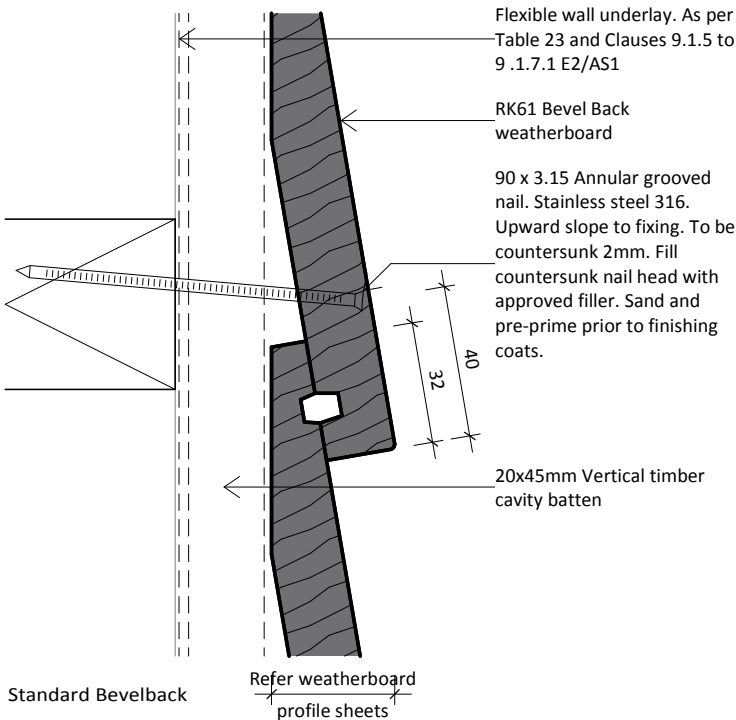
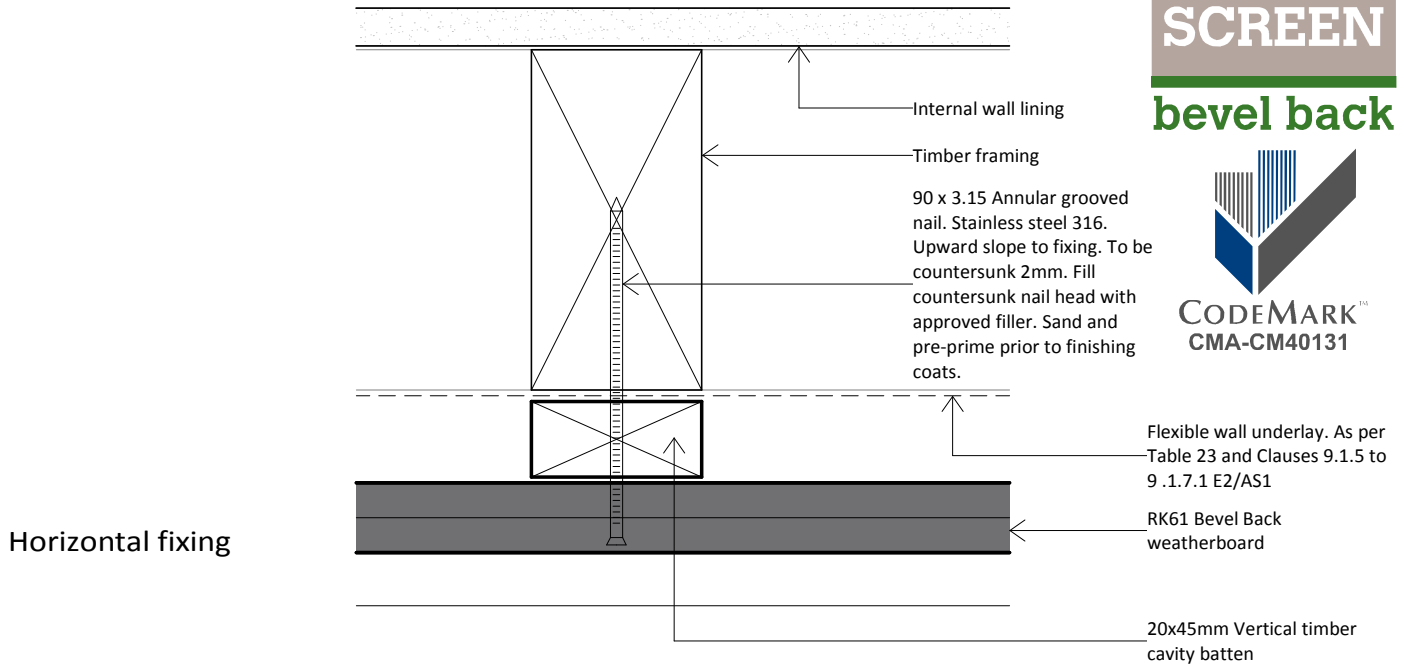

Vertical fixing



www.rosenfeldkidson.co.nz

Auckland Branch:
513 Mt Wellington Highway
Mt Wellington, Auckland 1060
T. +64 9 573 0503
F. +64 9 573 0504

Christchurch Branch:
15 Edmonton Road, Hornby
Christchurch 8042
T. +64 3 349 3316
F. +64 3 349 3317

Postal address: PO Box 621, Shortland Street, Auckland 1140

Title **Nail Fixing Detail**

Drawing

RKB-C-49

Scale 1 : 2 @ A4

Date 20.11.2014

1. Scope as per Clauses 1.0 and 9.4 E2/AS1
2. Profiles as per NZS 3617 Branz Bulletin 411
3. Fixings as per Table 24 E2/AS1
4. Compatibility of materials as per Tables 20-22 E2/AS1
5. Flashing as per Clause 4.0 E2/AS1
6. Rigid and flexible underlay as per Table 23 and Clauses 9.1.5 to 9.1.7 E2/AS1 or proprietary approved alternative
7. All weatherboards to be factory oiled to all faces and weathergrooves prior to installation
8. The weatherboard system relies on the joinery meeting the requirements of NZS 4211 for the relevant building windzone or wind pressure.



bevel back



CODEMARK™
CMA-CM40131

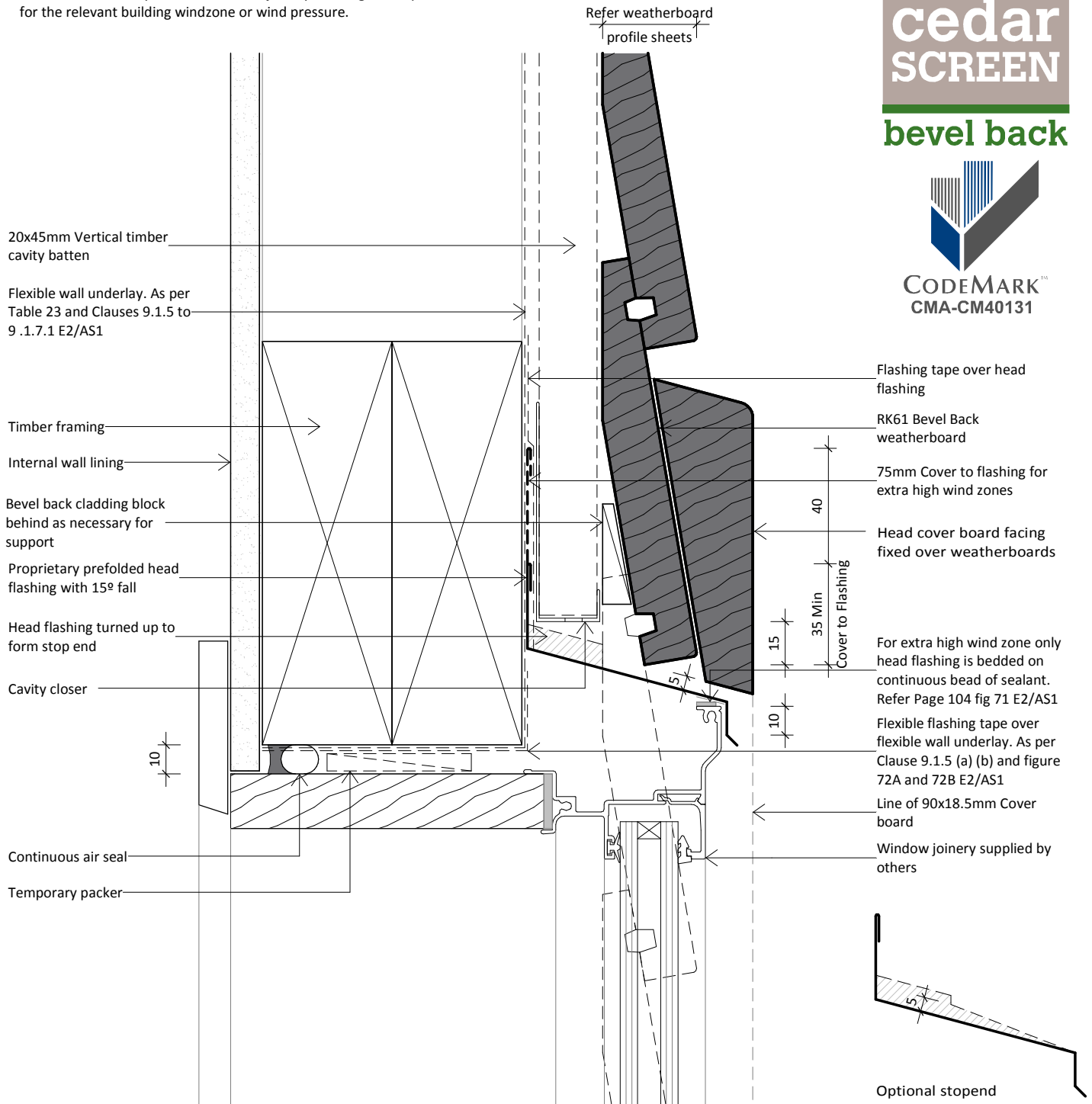

**Rosenfeld
Kidson**

www.rosenfeldkidson.co.nz

Auckland Branch:
513 Mt Wellington Highway
Mt Wellington, Auckland 1060
T. +64 9 573 0503
F. +64 9 573 0504

Christchurch Branch:
15 Edmonton Road, Hornby
Christchurch 8042
T. +64 3 349 3316
F. +64 3 349 3317

Postal address: PO Box 621, Shortland Street, Auckland 1140

Title **Aluminium Boxed Head
Detail - Option**

Drawing **RKB-C-91**

Scale 1 : 2 @ A4 Date 20.11.2014

1. Scope as per Clauses 1.0 and 9.4 E2/AS1
2. Profiles as per NZS 3617 Branz Bulletin 411
3. Fixings as per Table 24 E2/AS1
4. Compatibility of materials as per Tables 20-22 E2/AS1
5. Flashing as per Clause 4.0 E2/AS1
6. Rigid and flexible underlay as per Table 23 and Clauses 9.1.5 to 9.1.7 E2/AS1 or proprietary approved alternative
7. All weatherboards to be factory oiled to all faces and weathergrooves prior to installation
8. The weatherboard system relies on the joinery meeting the requirements of NZS 4211 for the relevant building windzone or wind pressure.



bevel back



CODEMARK™
CMA-CM40131

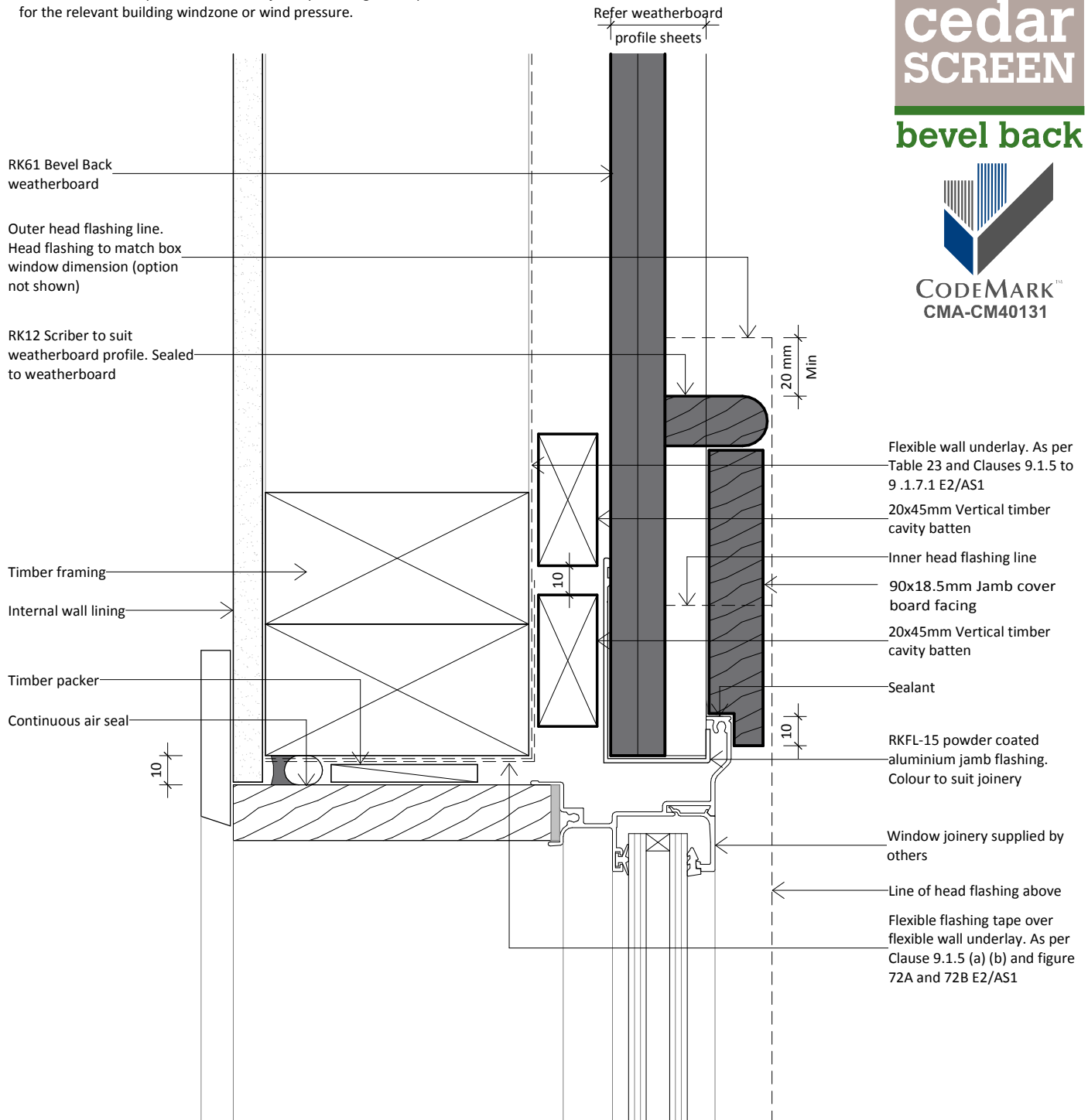

www.rosenfeldkidson.co.nz

Auckland Branch:
513 Mt Wellington Highway
Mt Wellington, Auckland 1060
T. +64 9 573 0503
F. +64 9 573 0504

Christchurch Branch:
15 Edmonton Road, Hornby
Christchurch 8042
T. +64 3 349 3316
F. +64 3 349 3317

Postal address: PO Box 621, Shortland Street, Auckland 1140

Title **Aluminium Boxed Jamb Detail - Option**

Drawing **RKB-C-92**

Scale 1 : 2 @ A4 Date 20.11.2014

1. Scope as per Clauses 1.0 and 9.4 E2/AS1
2. Profiles as per NZS 3617 Branz Bulletin 411
3. Fixings as per Table 24 E2/AS1
4. Compatibility of materials as per Tables 20-22 E2/AS1
5. Flashing as per Clause 4.0 E2/AS1
6. Rigid and flexible underlay as per Table 23 and Clauses 9.1.5 to 9.1.7 E2/AS1 or proprietary approved alternative
7. All weatherboards to be factory oiled to all faces and weathergrooves prior to installation
8. The weatherboard system relies on the joinery meeting the requirements of NZS 4211 for the relevant building windzone or wind pressure.



bevel back



CODEMARK™
CMA-CM40131

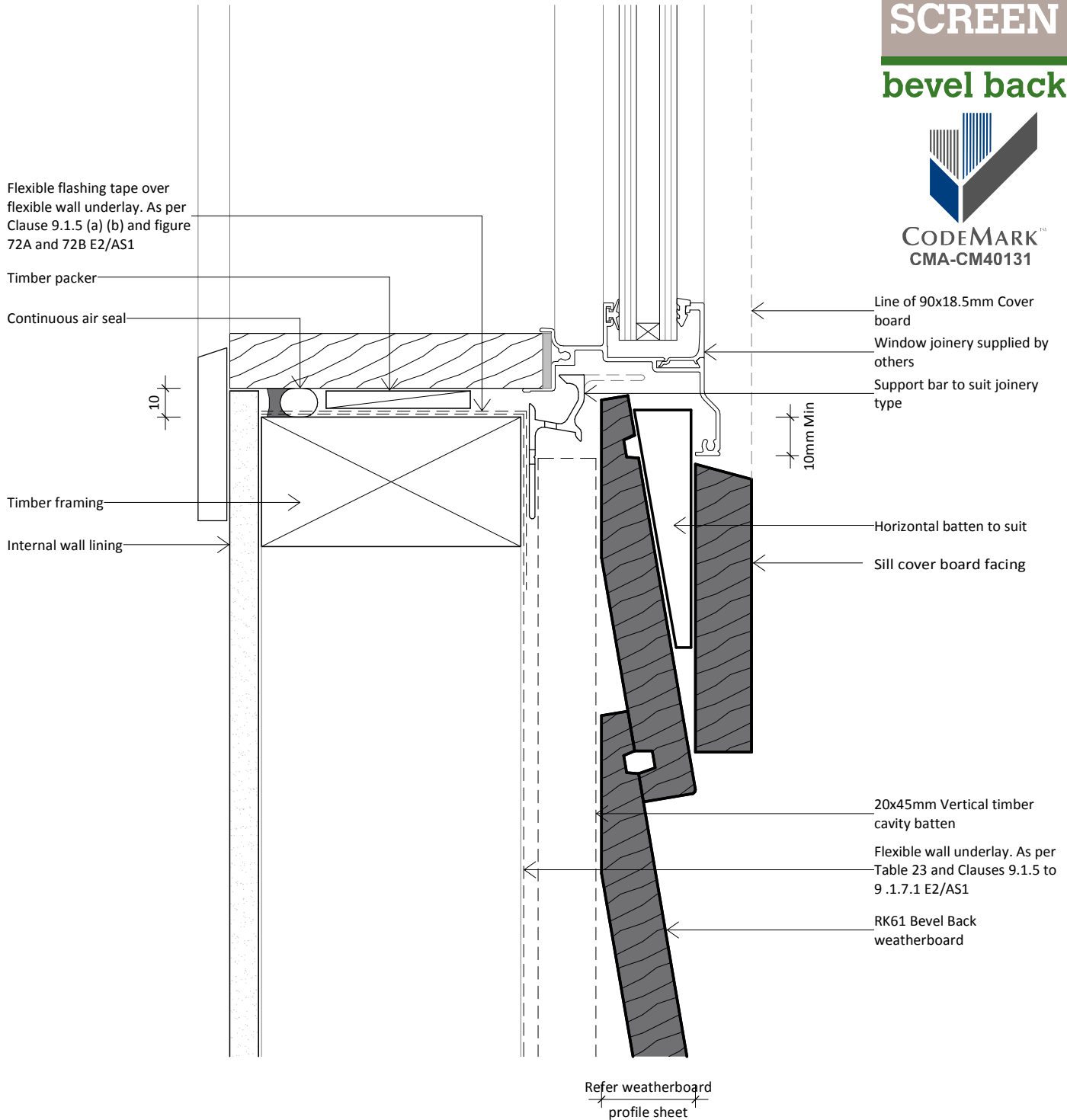

**Rosenfeld
Kidson**

www.rosenfeldkidson.co.nz

Auckland Branch:
513 Mt Wellington Highway
Mt Wellington, Auckland 1060
T. +64 9 573 0503
F. +64 9 573 0504

Christchurch Branch:
15 Edmonton Road, Hornby
Christchurch 8042
T. +64 3 349 3316
F. +64 3 349 3317

Postal address: PO Box 621, Shortland Street, Auckland 1140

Title **Aluminium Boxed Sill
Detail - Option**

Drawing **RKB-C-93**

Scale 1 : 2 @ A4 Date 20.11.2014

1. Scope as per Clauses 1.0 and 9.4 E2/AS1
2. Profiles as per NZS 3617 Branz Bulletin 411
3. Fixings as per Table 24 E2/AS1
4. Compatibility of materials as per Tables 20-22 E2/AS1
5. Flashing as per Clause 4.0 E2/AS1
6. Rigid and flexible underlay as per Table 23 and Clauses 9.1.5 to 9.1.7 E2/AS1 or proprietary approved alternative
7. All weatherboards to be factory oiled to all faces and weathergrooves prior to installation
8. The weatherboard system relies on the joinery meeting the requirements of NZS 4211 for the relevant building windzone or wind pressure.



bevel back



CODEMARK™
CMA-CM40131

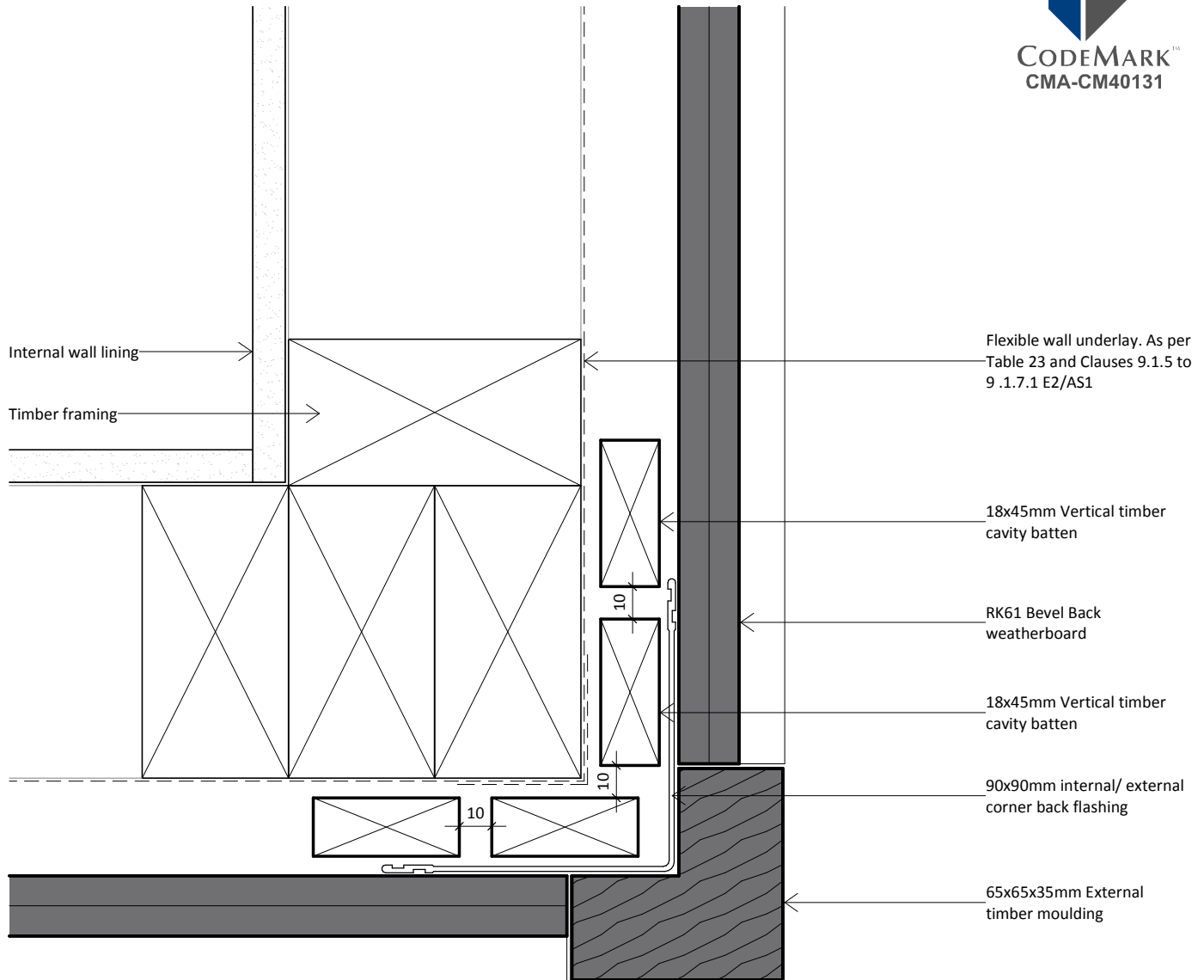

www.rosenfeldkidson.co.nz

Auckland Branch:
513 Mt Wellington Highway
Mt Wellington, Auckland 1060
T. +64 9 573 0503
F. +64 9 573 0504

Christchurch Branch:
15 Edmonton Road, Hornby
Christchurch 8042
T. +64 3 349 3316
F. +64 3 349 3317

Postal address: PO Box 621, Shortland Street, Auckland 1140

Title **External Corner Detail - Option**

Drawing **RKB-C-94**

Scale 1 : 2 @ A4 Date 20.11.2014