

Rusticated Weatherboard - Direct Fixed on Flexible Underlay



Drawing	Sheet Name	Date
Typical Details		
RKR-D-00	Index V1	12.10.2020
RKR-SETOUT	Weatherboard Setout	12.10.2020
RKR-MOULD	RK Profiles	12.10.2020
RKR-FIXINGS	RK Fixings	12.10.2020
RKR-FLG-01	Flashing Details	12.10.2020
Window Details		
RKR-D-01	Aluminium Head Detail	12.10.2020
RKR-D-02	Aluminium Jamb Detail	12.10.2020
RKR-D-03	Aluminium Sill Detail	12.10.2020
Internal Corner Details		
RKR-D-11	Internal Corner RK41 Detail - Option 1	12.10.2020
External Corner Details		
RKR-D-21	External Corner RK42 Detail - Option 1	12.10.2020
RKR-D-22	External Corner Detail - Option 2	12.10.2020
RKR-D-23	External Corner RK97 Detail - Option 3	12.10.2020
Vertical Details		
RKR-D-41	Bottom Plate Detail	12.10.2020
RKR-D-42	Top Plate to Soffit Detail	12.10.2020
RKR-D-43	Barge Detail	12.10.2020
RKR-D-44	Soffit Detail	12.10.2020
RKR-D-46	Nail Fixing Detail	12.10.2020
RKR-D-47	Nail Fixing Detail (Paint Finish Only)	12.10.2020



www.rosenfeldkidson.co.nz

Postal address: PO Box 621,
Shortland Street, Auckland 1140

Auckland Branch:
 T: +64 9 573 0503
 F: +64 9 573 0504
 513 Mt Wellington Highway
 Mt Wellington, Auckland 1060

Christchurch Branch:
 T: +64 3 349 3316
 F: +64 3 349 3317
 15 Edmonton Road
 Hornby, Christchurch 8042

Title **Index V1**

Drawing **RKR-D-00**

Scale @ A4 Date 12.10.2020

RKA702 Weatherboards

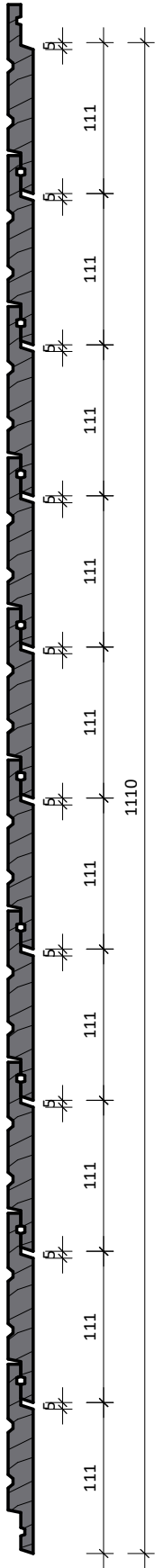

RKA704 Weatherboards

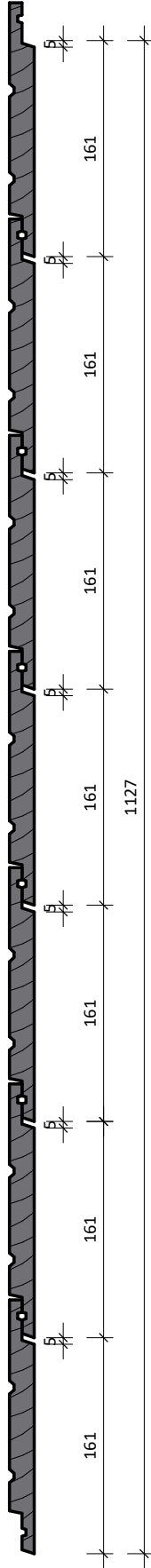

Random Width Weatherboards

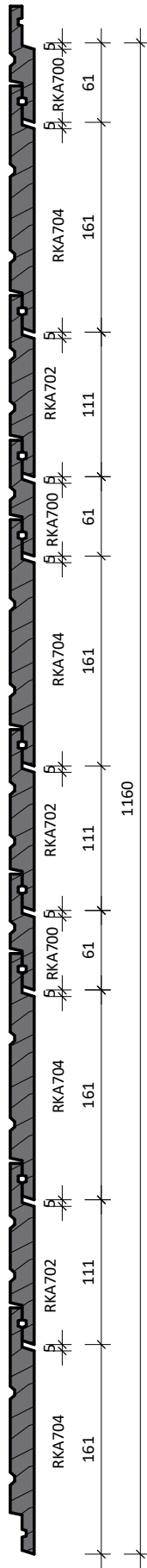

Random Depth & Width Weatherboards

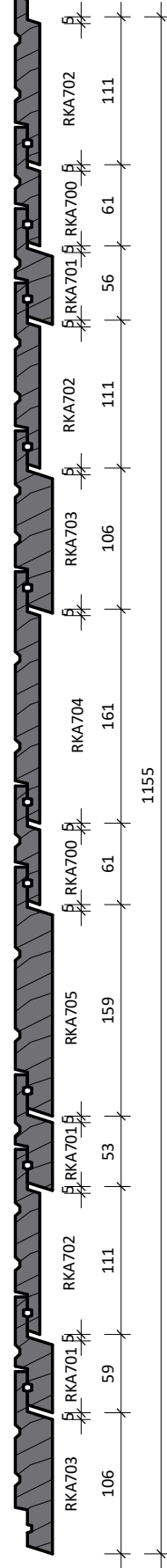

www.rosenfeldkidson.co.nz

Postal address: PO Box 621,
Shortland Street, Auckland 1140

Auckland Branch:
T: +64 9 573 0503
F: +64 9 573 0504
513 Mt Wellington Highway
Mt Wellington, Auckland 1060

Christchurch Branch:
T: +64 3 349 3316
F: +64 3 349 3317
15 Edmonton Road
Hornby, Christchurch 8042



Title **Weatherboard Setout**

Drawing **RKR-SETOUT**

Scale 1 : 5 @ A4 Date 12.10.2020

1. Scope as per Clauses 1.0 and 9.4 E2/AS1
2. Profiles as per NZS 3617, Branz Bulletin 411 and/or compliance achieved through in-service history, length of service not less than 15 years in all NZ environments B2/VM1 1.1.1 (a)
3. Fixings as per Table 24 E2/AS1
4. Compatibility of materials as per Tables 20-22 E2/AS1
5. Flashing as per Clause 4.0 E2/AS1
6. Rigid and flexible underlay as per Table 23 and Clauses 9.1.5 to 9.1.7 E2/AS1 or proprietary approved alternative
7. All weatherboards to be factory oiled to all faces and weathergrooves prior to installation, ensure maintenance is to manufacturers recommendations
8. The weatherboard system relies on the joinery meeting the requirements of NZS 4211 for the relevant building windzone or wind pressure
9. Timber to NZBC B2 Durability B2.3.1(b), Western Red Cedar, Larch and Truwood®
10. Timber framing to NZS 3604:2011

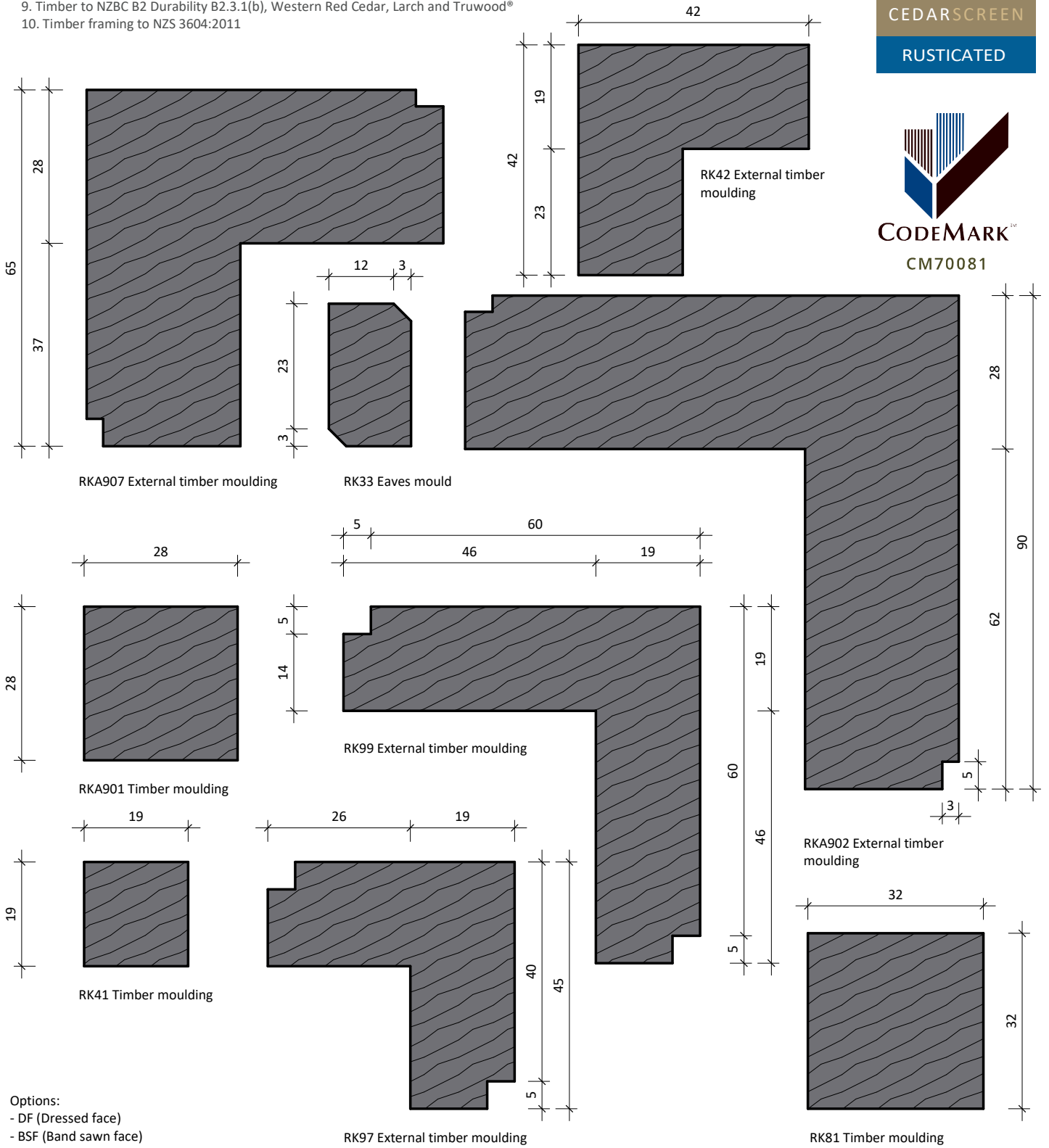

Options:
 - DF (Dressed face)
 - BSF (Band sawn face)



www.rosenfeldkidson.co.nz

Postal address: PO Box 621,
 Shortland Street, Auckland 1140

Auckland Branch:
 T: +64 9 573 0503
 F: +64 9 573 0504
 513 Mt Wellington Highway
 Mt Wellington, Auckland 1060

Christchurch Branch:
 T: +64 3 349 3316
 F: +64 3 349 3317
 15 Edmonton Road
 Hornby, Christchurch 8042

Title **RK Profiles**

Drawing

RKR-MOULD

Scale 1 : 1 @ A4

Date 12.10.2020

1. Scope as per Clauses 1.0 and 9.4 E2/AS1
2. Profiles as per NZS 3617, Branz Bulletin 411 and/or compliance achieved through in-service history, length of service not less than 15 years in all NZ environments B2/VM1 1.1.1 (a)
3. Fixings as per Table 24 E2/AS1
4. Compatibility of materials as per Tables 20-22 E2/AS1
5. Flashing as per Clause 4.0 E2/AS1
6. Rigid and flexible underlay as per Table 23 and Clauses 9.1.5 to 9.1.7 E2/AS1 or proprietary approved alternative
7. All weatherboards to be factory oiled to all faces and weathergrooves prior to installation, ensure maintenance is to manufacturers recommendations
8. The weatherboard system relies on the joinery meeting the requirements of NZS 4211 for the relevant building windzone or wind pressure
9. Timber to NZBC B2 Durability B2.3.1(b), Western Red Cedar, Larch and Truwood®
10. Timber framing to NZS 3604:2011



RK Cladding Fixings

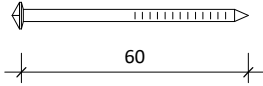

Direct fixed 60 x 3.15mm

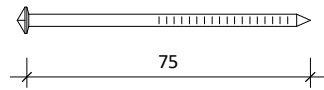

Flexible underlay 75 x 3.15mm

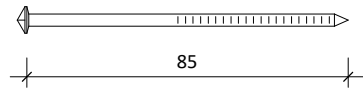

Rigid underlay 85 x 3.15mm

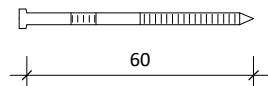

Cavity fixed 60 x 3.15mm Stainless steel nail
Jolthead nail for paint finish weatherboards.

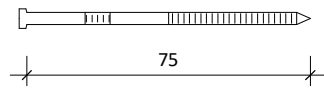

Cavity fixed 75 x 3.15mm Stainless steel nail
Jolthead nail for paint finish weatherboards.

RK Plug Nail Range

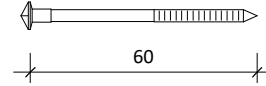

Cedarscreen Plug Nail 60 x 3.15mm

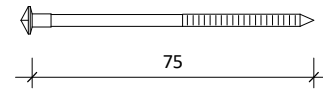

Cedarscreen Plug Nail 75 x 3.15mm

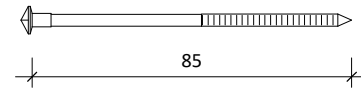

Cedarscreen Plug Nail 85 x 3.15mm

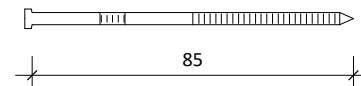

Cavity fixed 85 x 3.15mm Stainless steel nail
Jolthead nail for paint finish weatherboards.



RK Structural Fixings

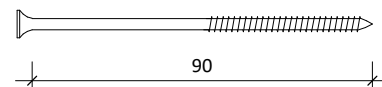

- ASSY 90x12g Stainless steel screws
- RK-S2 90x12g Stainless steel screws

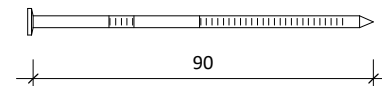

90 x 3.30mm Stainless steel 316 Annular groove nail

Options:

- Silicon bronze annular grooved
- Stainless steel 316 grade annular grooved
- All fixings to be annular groove



www.rosenfeldkidson.co.nz

Postal address: PO Box 621,
Shortland Street, Auckland 1140

Auckland Branch:

T: +64 9 573 0503
F: +64 9 573 0504
513 Mt Wellington Highway
Mt Wellington, Auckland 1060

Christchurch Branch:

T: +64 3 349 3316
F: +64 3 349 3317
15 Edmonton Road
Hornby, Christchurch 8042

Title **RK Fixings**

Drawing

RKR-FIXINGS

Scale 1 : 2 @ A4

Date 12.10.2020

1. Scope as per Clauses 1.0 and 9.4 E2/AS1
2. Profiles as per NZS 3617, Branz Bulletin 411 and/or compliance achieved through in-service history, length of service not less than 15 years in all NZ environments B2/VM1 1.1.1 (a)
3. Fixings as per Table 24 E2/AS1
4. Compatibility of materials as per Tables 20-22 E2/AS1
5. Flashing as per Clause 4.0 E2/AS1
6. Rigid and flexible underlay as per Table 23 and Clauses 9.1.5 to 9.1.7 E2/AS1 or proprietary approved alternative
7. All weatherboards to be factory oiled to all faces and weathergrooves prior to installation, ensure maintenance is to manufacturers recommendations
8. The weatherboard system relies on the joinery meeting the requirements of NZS 4211 for the relevant building windzone or wind pressure
9. Timber to NZBC B2 Durability B2.3.1(b), Western Red Cedar, Larch and Truwood®
10. Timber framing to NZS 3604:2011

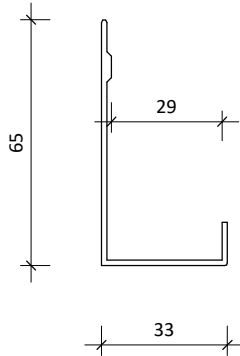

RKFL-17 powder coated aluminium jamb flashing.

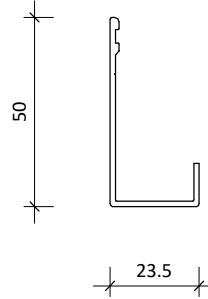

RKFL-11 powder coated aluminum jamb flashing

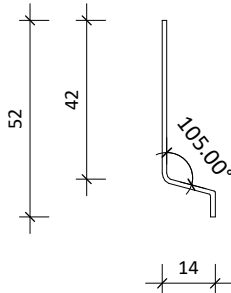

RKFL-12 42x14mm Cavity closer. Tack cavity closer @ 600mm crs

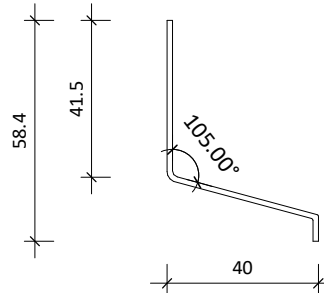

RKFL-14 Cavity closer. Tack cavity closer @ 600mm crs

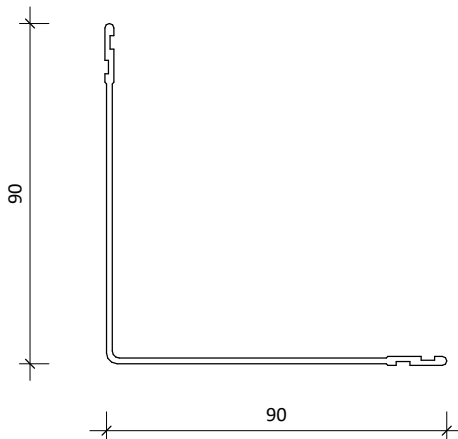

RKFL-10 internal/ external corner back flashing to suit extra high wind zone

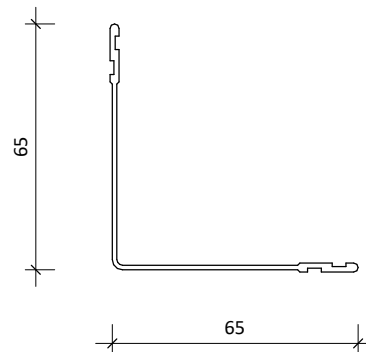

RKFL-09 65x65mm internal/ external corner back flashing



www.rosenfeldkidson.co.nz

Postal address: PO Box 621,
Shortland Street, Auckland 1140

Auckland Branch:
T: +64 9 573 0503
F: +64 9 573 0504
513 Mt Wellington Highway
Mt Wellington, Auckland 1060

Christchurch Branch:
T: +64 3 349 3316
F: +64 3 349 3317
15 Edmonton Road
Hornby, Christchurch 8042

Title **Flashing Details**

Drawing

RKR-FLG-01

Scale 1 : 2 @ A4

Date 12.10.2020

1. Scope as per Clauses 1.0 and 9.4 E2/AS1
2. Profiles as per NZS 3617, Branz Bulletin 411 and/or compliance achieved through in-service history, length of service not less than 15 years in all NZ environments B2/VM1 1.1.1 (a)
3. Fixings as per Table 24 E2/AS1
4. Compatibility of materials as per Tables 20-22 E2/AS1
5. Flashing as per Clause 4.0 E2/AS1
6. Rigid and flexible underlay as per Table 23 and Clauses 9.1.5 to 9.1.7 E2/AS1 or proprietary approved alternative
7. All weatherboards to be factory oiled to all faces and weathergrooves prior to installation, ensure maintenance is to manufacturers recommendations
8. The weatherboard system relies on the joinery meeting the requirements of NZS 4211 for the relevant building windzone or wind pressure
9. Timber to NZBC B2 Durability B2.3.1(b), Western Red Cedar, Larch and Truwood®
10. Timber framing to NZS 3604:2011

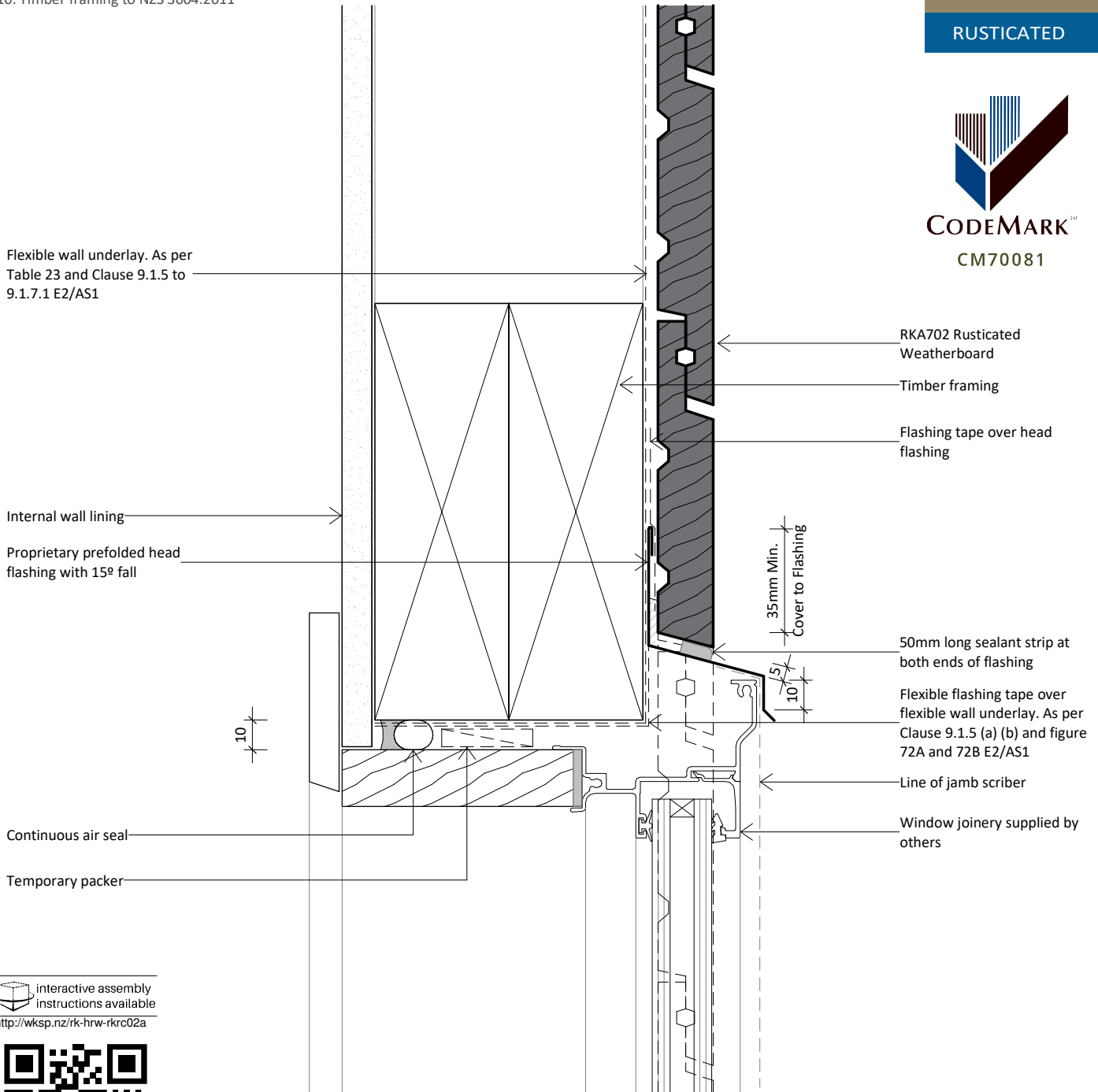

interactive assembly instructions available
<http://wksp.nz/rk-hrw-rkrc02a>



get WorkingSpec from Apple App Store or Google Play



www.rosenfeldkidson.co.nz

Postal address: PO Box 621,
Shortland Street, Auckland 1140

Auckland Branch:
 T: +64 9 573 0503
 F: +64 9 573 0504
 513 Mt Wellington Highway
 Mt Wellington, Auckland 1060

Christchurch Branch:
 T: +64 3 349 3316
 F: +64 3 349 3317
 15 Edmonton Road
 Hornby, Christchurch 8042

Title **Aluminium Head Detail**

Drawing
RKR-D-01

Scale 1 : 2 @ A4 Date 12.10.2020

1. Scope as per Clauses 1.0 and 9.4 E2/AS1
2. Profiles as per NZS 3617, Branz Bulletin 411 and/or compliance achieved through in-service history, length of service not less than 15 years in all NZ environments B2/VM1 1.1.1 (a)
3. Fixings as per Table 24 E2/AS1
4. Compatibility of materials as per Tables 20-22 E2/AS1
5. Flashing as per Clause 4.0 E2/AS1
6. Rigid and flexible underlay as per Table 23 and Clauses 9.1.5 to 9.1.7 E2/AS1 or proprietary approved alternative
7. All weatherboards to be factory oiled to all faces and weathergrooves prior to installation, ensure maintenance is to manufacturers recommendations
8. The weatherboard system relies on the joinery meeting the requirements of NZS 4211 for the relevant building windzone or wind pressure
9. Timber to NZBC B2 Durability B2.3.1(b), Western Red Cedar, Larch and Truwood®
10. Timber framing to NZS 3604:2011

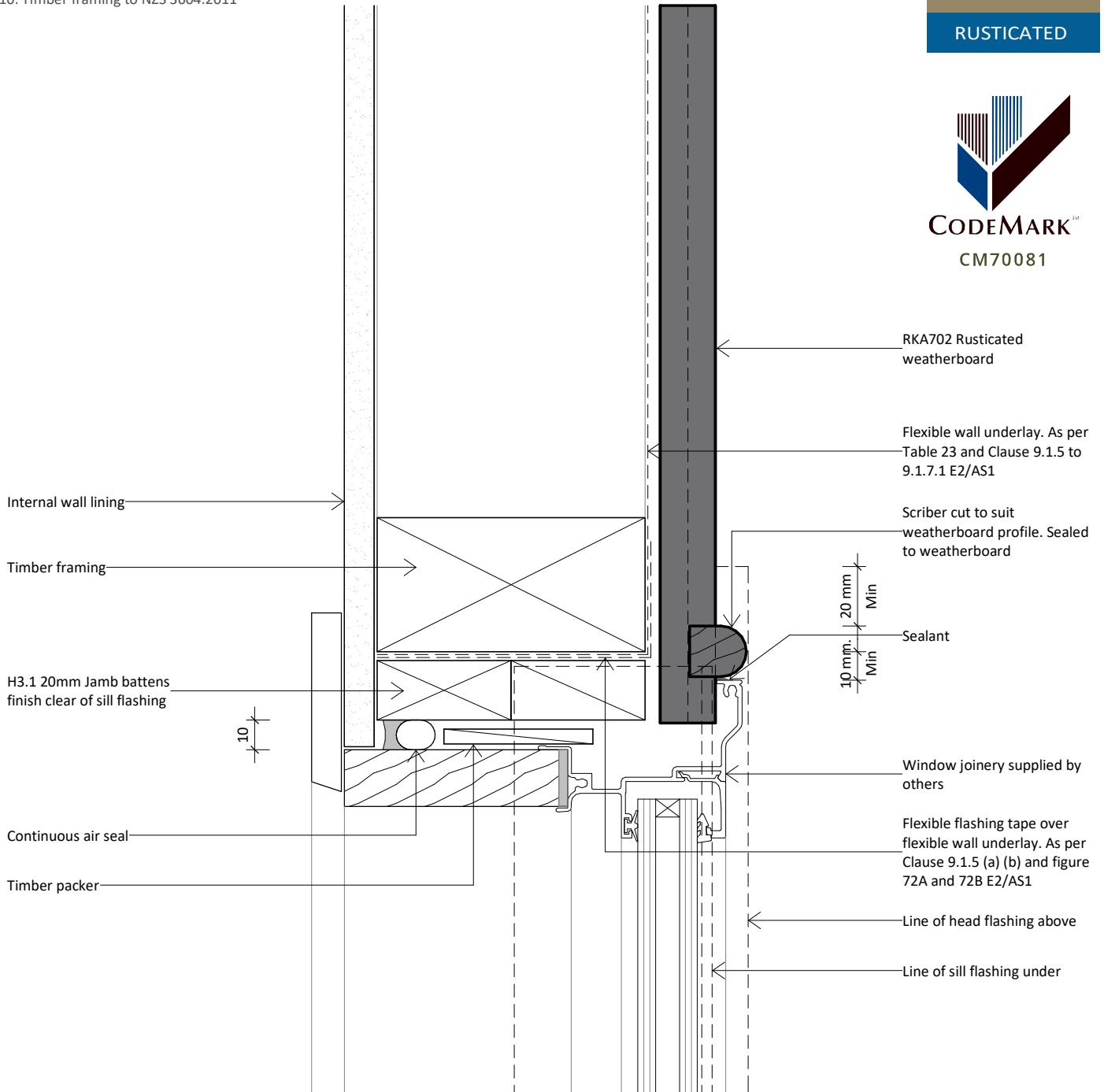

www.rosenfeldkidson.co.nz

Postal address: PO Box 621,
Shortland Street, Auckland 1140

Auckland Branch:
T: +64 9 573 0503
F: +64 9 573 0504
513 Mt Wellington Highway
Mt Wellington, Auckland 1060

Christchurch Branch:
T: +64 3 349 3316
F: +64 3 349 3317
15 Edmonton Road
Hornby, Christchurch 8042

Title **Aluminium Jamb Detail**

Drawing
RKR-D-02

Scale 1 : 2 @ A4 Date 12.10.2020

1. Scope as per Clauses 1.0 and 9.4 E2/AS1
2. Profiles as per NZS 3617, Branz Bulletin 411 and/or compliance achieved through in-service history, length of service not less than 15 years in all NZ environments B2/VM1 1.1.1 (a)
3. Fixings as per Table 24 E2/AS1
4. Compatibility of materials as per Tables 20-22 E2/AS1
5. Flashing as per Clause 4.0 E2/AS1
6. Rigid and flexible underlay as per Table 23 and Clauses 9.1.5 to 9.1.7 E2/AS1 or proprietary approved alternative
7. All weatherboards to be factory oiled to all faces and weathergrooves prior to installation, ensure maintenance is to manufacturers recommendations
8. The weatherboard system relies on the joinery meeting the requirements of NZS 4211 for the relevant building windzone or wind pressure
9. Timber to NZBC B2 Durability B2.3.1(b), Western Red Cedar, Larch and Truwood®
10. Timber framing to NZS 3604:2011



Flexible flashing tape over flexible wall underlay. As per Clause 9.1.5 (a) (b) and figure 72A and 72B E2/AS1

Timber packer

Continuous air seal

10

Timber framing

Internal wall lining

Window joinery supplied by others

Frame block

5mm Gap without seal
10mm Min
35mm Min
Flashing Cover

Sill flashing to extend behind joinery frame 8mm min. Refer figure 72A NZBC E2/AS1

RKA702 Rusticated weatherboard

Flexible wall underlay. As per Table 23 and Clause 9.1.5 to 9.1.7.1 E2/AS1

interactive assembly instructions available
<http://wksp.nz/rk-hrw-rkrc02a>



get WorkingSpec from Apple App Store or Google Play



www.rosenfeldkidson.co.nz

Postal address: PO Box 621, Shortland Street, Auckland 1140

Auckland Branch:

T: +64 9 573 0503

F: +64 9 573 0504

513 Mt Wellington Highway

Mt Wellington, Auckland 1060

Christchurch Branch:

T: +64 3 349 3316

F: +64 3 349 3317

15 Edmonton Road

Hornby, Christchurch 8042

Title **Aluminium Sill Detail**

Drawing

RKR-D-03

Scale 1 : 2 @ A4

Date 12.10.2020

1. Scope as per Clauses 1.0 and 9.4 E2/AS1
2. Profiles as per NZS 3617, Branz Bulletin 411 and/or compliance achieved through in-service history, length of service not less than 15 years in all NZ environments B2/VM1 1.1.1 (a)
3. Fixings as per Table 24 E2/AS1
4. Compatibility of materials as per Tables 20-22 E2/AS1
5. Flashing as per Clause 4.0 E2/AS1
6. Rigid and flexible underlay as per Table 23 and Clauses 9.1.5 to 9.1.7 E2/AS1 or proprietary approved alternative
7. All weatherboards to be factory oiled to all faces and weathergrooves prior to installation, ensure maintenance is to manufacturers recommendations
8. The weatherboard system relies on the joinery meeting the requirements of NZS 4211 for the relevant building windzone or wind pressure
9. Timber to NZBC B2 Durability B2.3.1(b), Western Red Cedar, Larch and Truwood®
10. Timber framing to NZS 3604:2011

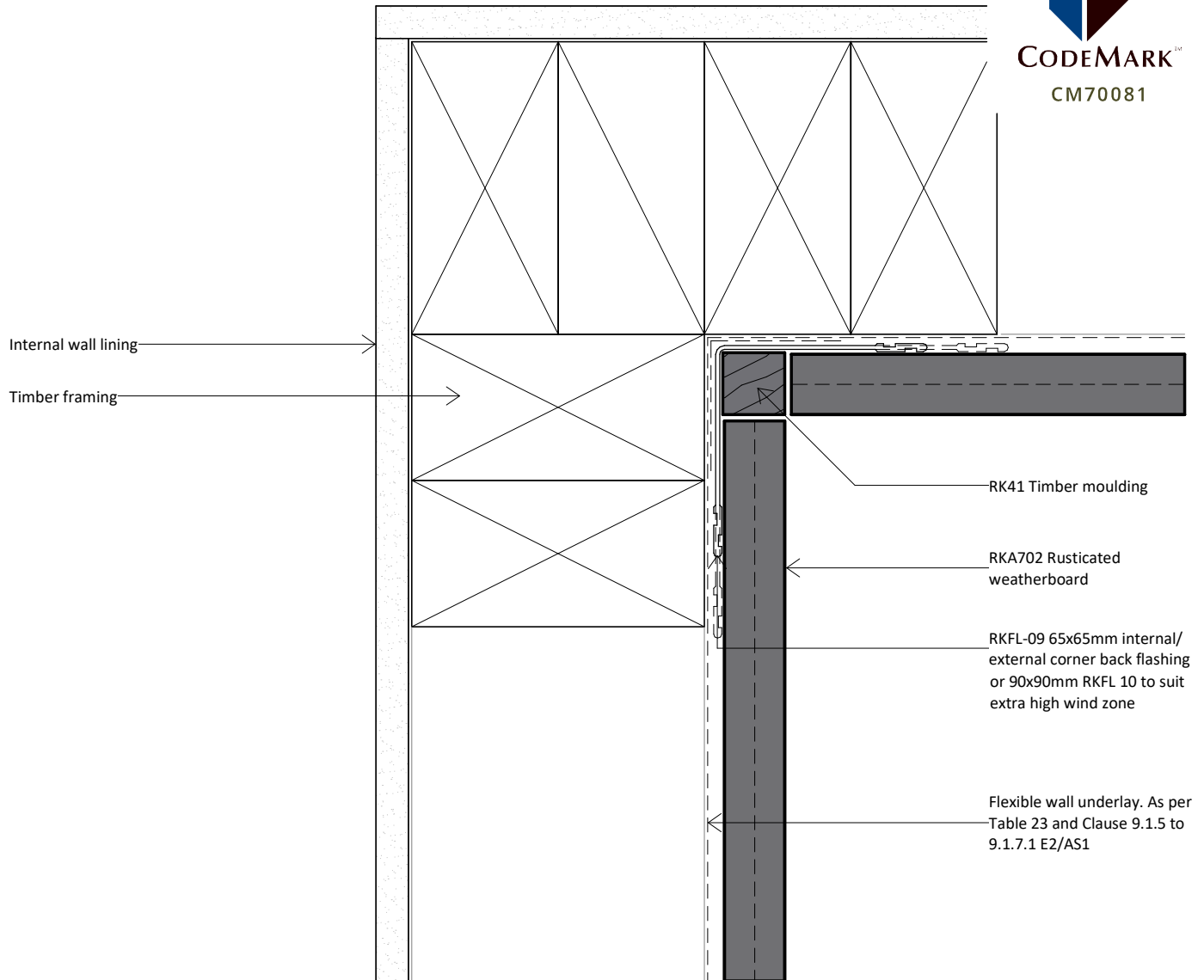

www.rosenfeldkidson.co.nz

Postal address: PO Box 621,
Shortland Street, Auckland 1140

Auckland Branch:
 T: +64 9 573 0503
 F: +64 9 573 0504
 513 Mt Wellington Highway
 Mt Wellington, Auckland 1060

Christchurch Branch:
 T: +64 3 349 3316
 F: +64 3 349 3317
 15 Edmonton Road
 Hornby, Christchurch 8042

Title **Internal Corner RK41 Detail
- Option 1**

Drawing
RKR-D-11

Scale 1 : 2 @ A4 Date 12.10.2020

1. Scope as per Clauses 1.0 and 9.4 E2/AS1
2. Profiles as per NZS 3617, Branz Bulletin 411 and/or compliance achieved through in-service history, length of service not less than 15 years in all NZ environments B2/VM1 1.1.1 (a)
3. Fixings as per Table 24 E2/AS1
4. Compatibility of materials as per Tables 20-22 E2/AS1
5. Flashing as per Clause 4.0 E2/AS1
6. Rigid and flexible underlay as per Table 23 and Clauses 9.1.5 to 9.1.7 E2/AS1 or proprietary approved alternative
7. All weatherboards to be factory oiled to all faces and weathergrooves prior to installation, ensure maintenance is to manufacturers recommendations
8. The weatherboard system relies on the joinery meeting the requirements of NZS 4211 for the relevant building windzone or wind pressure
9. Timber to NZBC B2 Durability B2.3.1(b), Western Red Cedar, Larch and Truwood®
10. Timber framing to NZS 3604:2011

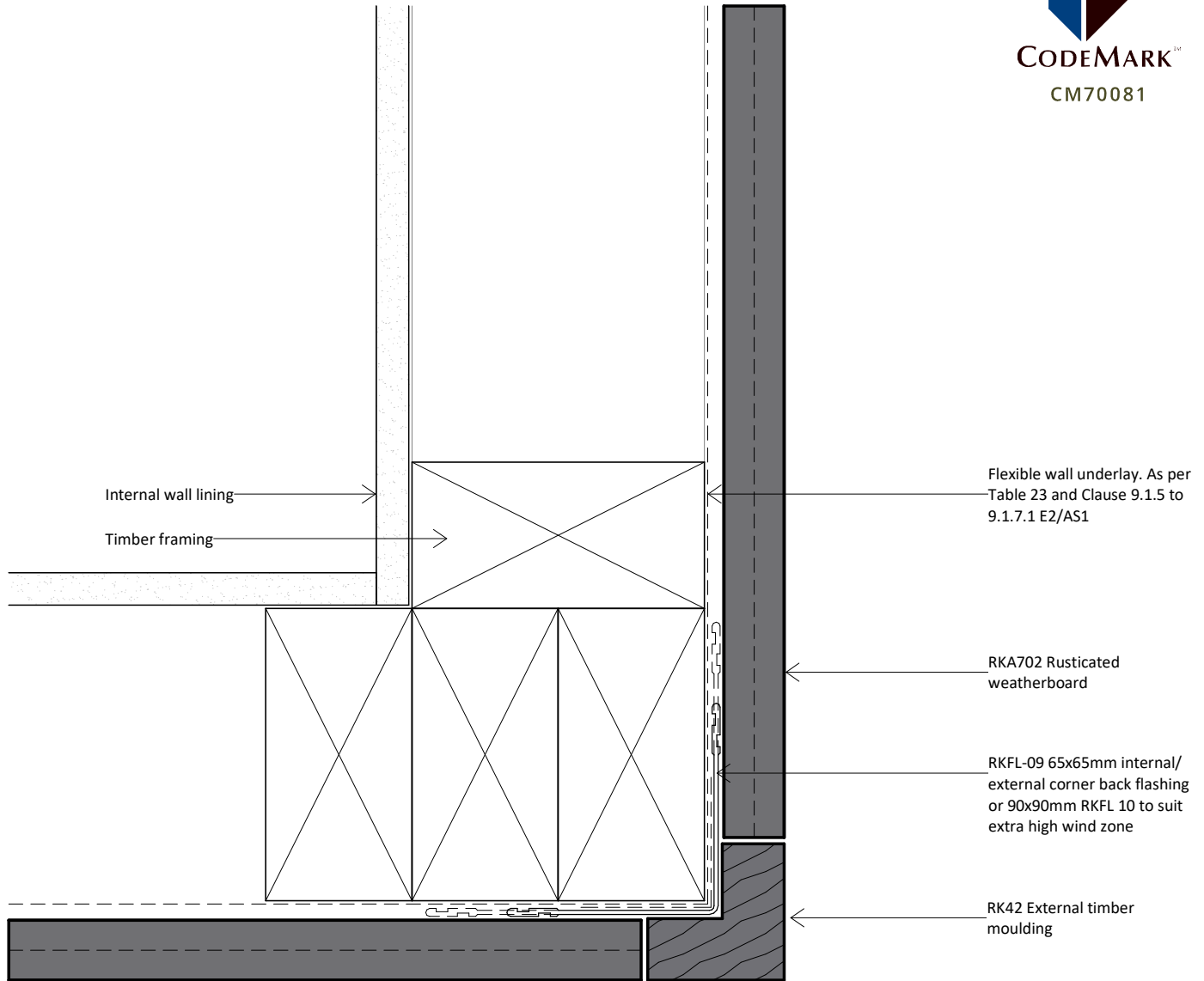

www.rosenfeldkidson.co.nz

Postal address: PO Box 621,
Shortland Street, Auckland 1140

Auckland Branch:
 T: +64 9 573 0503
 F: +64 9 573 0504
 513 Mt Wellington Highway
 Mt Wellington, Auckland 1060

Christchurch Branch:
 T: +64 3 349 3316
 F: +64 3 349 3317
 15 Edmonton Road
 Hornby, Christchurch 8042

Title **External Corner RK42
Detail - Option 1**

Drawing **RKR-D-21**

Scale 1 : 2 @ A4 Date 12.10.2020

1. Scope as per Clauses 1.0 and 9.4 E2/AS1
2. Profiles as per NZS 3617, Branz Bulletin 411 and/or compliance achieved through in-service history, length of service not less than 15 years in all NZ environments B2/VM1 1.1.1 (a)
3. Fixings as per Table 24 E2/AS1
4. Compatibility of materials as per Tables 20-22 E2/AS1
5. Flashing as per Clause 4.0 E2/AS1
6. Rigid and flexible underlay as per Table 23 and Clauses 9.1.5 to 9.1.7 E2/AS1 or proprietary approved alternative
7. All weatherboards to be factory oiled to all faces and weathergrooves prior to installation, ensure maintenance is to manufacturers recommendations
8. The weatherboard system relies on the joinery meeting the requirements of NZS 4211 for the relevant building windzone or wind pressure
9. Timber to NZBC B2 Durability B2.3.1(b), Western Red Cedar, Larch and Truwood®
10. Timber framing to NZS 3604:2011

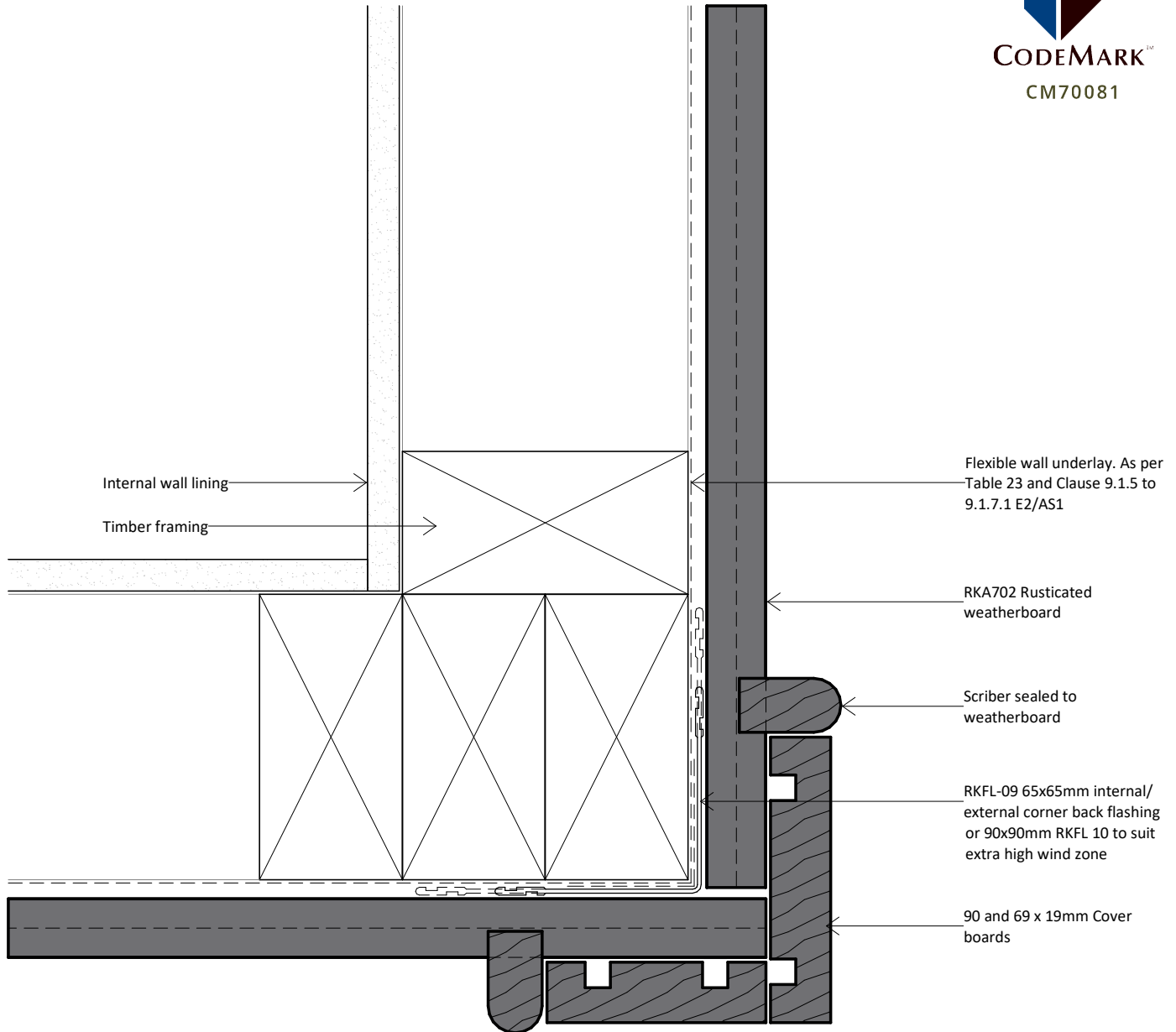

www.rosenfeldkidson.co.nz

Postal address: PO Box 621,
Shortland Street, Auckland 1140

Auckland Branch:
T: +64 9 573 0503
F: +64 9 573 0504
513 Mt Wellington Highway
Mt Wellington, Auckland 1060

Christchurch Branch:
T: +64 3 349 3316
F: +64 3 349 3317
15 Edmonton Road
Hornby, Christchurch 8042

Title **External Corner Detail -
Option 2**

Drawing
RKR-D-22

Scale 1 : 2 @ A4 Date 12.10.2020

1. Scope as per Clauses 1.0 and 9.4 E2/AS1
2. Profiles as per NZS 3617, Branz Bulletin 411 and/or compliance achieved through in-service history, length of service not less than 15 years in all NZ environments B2/VM1 1.1.1 (a)
3. Fixings as per Table 24 E2/AS1
4. Compatibility of materials as per Tables 20-22 E2/AS1
5. Flashing as per Clause 4.0 E2/AS1
6. Rigid and flexible underlay as per Table 23 and Clauses 9.1.5 to 9.1.7 E2/AS1 or proprietary approved alternative
7. All weatherboards to be factory oiled to all faces and weathergrooves prior to installation, ensure maintenance is to manufacturers recommendations
8. The weatherboard system relies on the joinery meeting the requirements of NZS 4211 for the relevant building windzone or wind pressure
9. Timber to NZBC B2 Durability B2.3.1(b), Western Red Cedar, Larch and Truwood®
10. Timber framing to NZS 3604:2011

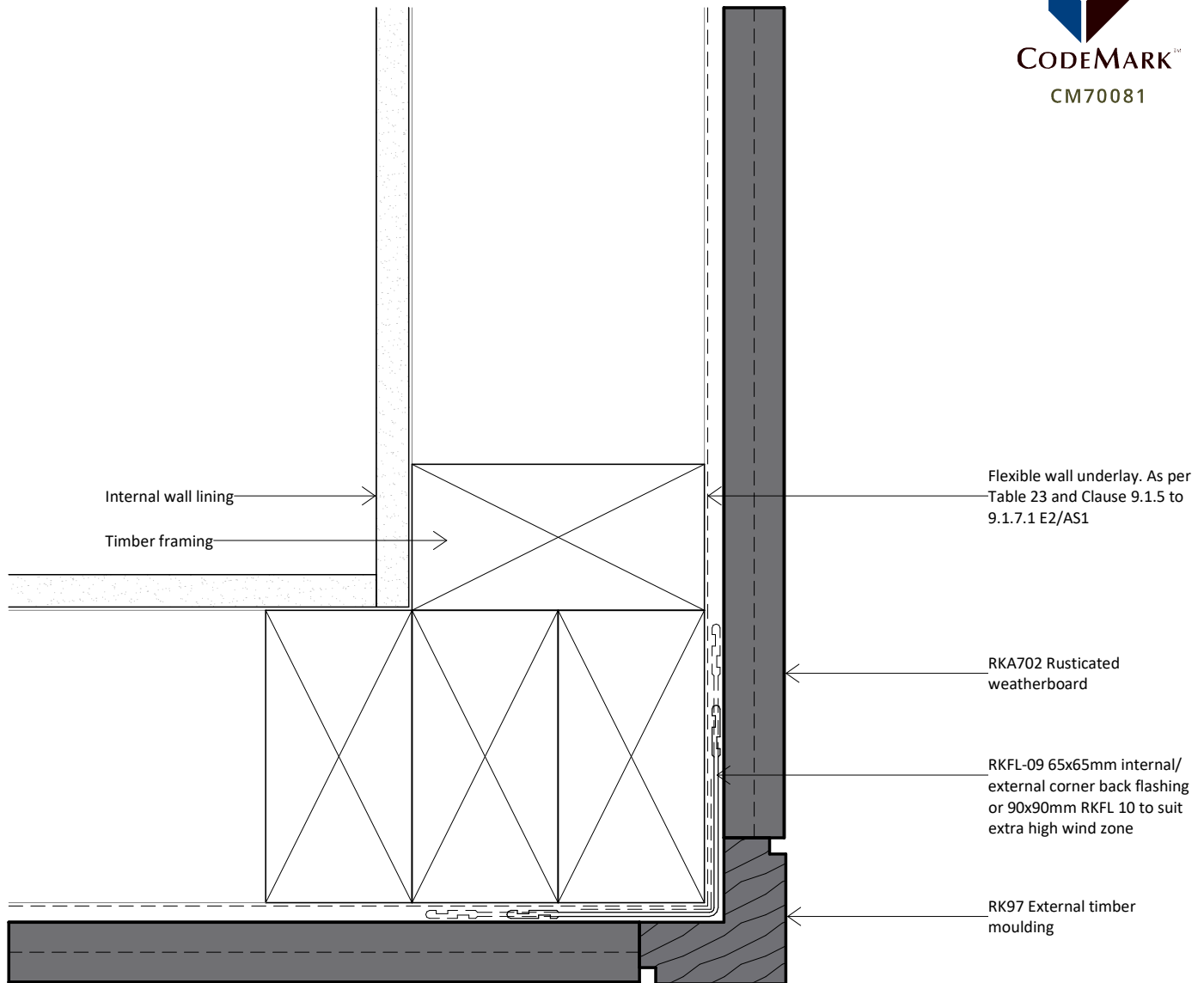

www.rosenfeldkidson.co.nz

Postal address: PO Box 621,
Shortland Street, Auckland 1140

Auckland Branch:

T: +64 9 573 0503
F: +64 9 573 0504
513 Mt Wellington Highway
Mt Wellington, Auckland 1060

Christchurch Branch:

T: +64 3 349 3316
F: +64 3 349 3317
15 Edmonton Road
Hornby, Christchurch 8042

Title **External Corner RK97
Detail - Option 3**

Drawing
RKR-D-23

Scale 1 : 2 @ A4 Date 12.10.2020

1. Scope as per Clauses 1.0 and 9.4 E2/AS1
2. Profiles as per NZS 3617, Branz Bulletin 411 and/or compliance achieved through in-service history, length of service not less than 15 years in all NZ environments B2/VM1 1.1.1 (a)
3. Fixings as per Table 24 E2/AS1
4. Compatibility of materials as per Tables 20-22 E2/AS1
5. Flashing as per Clause 4.0 E2/AS1
6. Rigid and flexible underlay as per Table 23 and Clauses 9.1.5 to 9.1.7 E2/AS1 or proprietary approved alternative
7. All weatherboards to be factory oiled to all faces and weathergrooves prior to installation, ensure maintenance is to manufacturers recommendations
8. The weatherboard system relies on the joinery meeting the requirements of NZS 4211 for the relevant building windzone or wind pressure
9. Timber to NZBC B2 Durability B2.3.1(b), Western Red Cedar, Larch and Truwood®
10. Timber framing to NZS 3604:2011

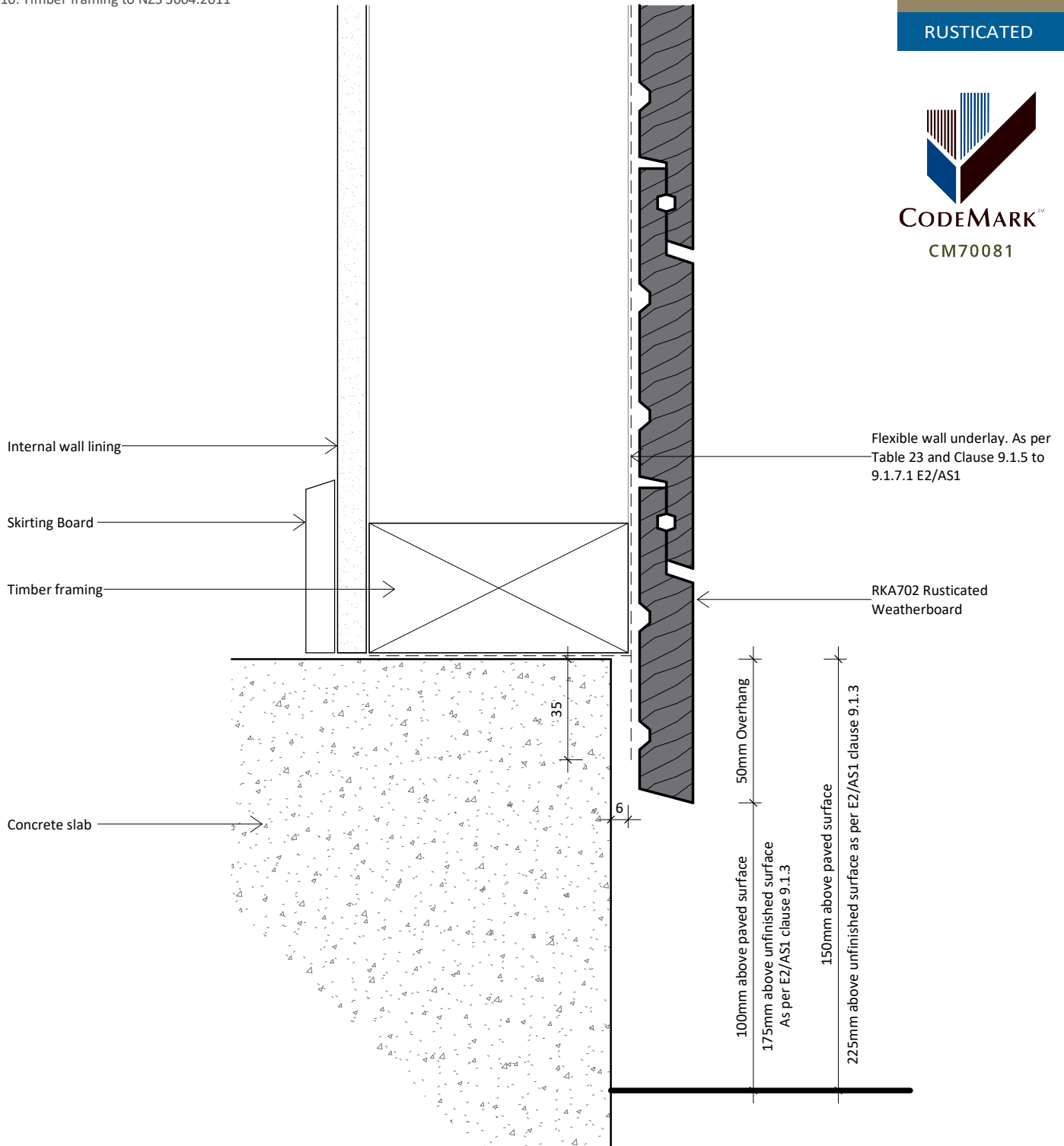

www.rosenfeldkidson.co.nz

Postal address: PO Box 621,
Shortland Street, Auckland 1140

Auckland Branch:
T: +64 9 573 0503
F: +64 9 573 0504
513 Mt Wellington Highway
Mt Wellington, Auckland 1060

Christchurch Branch:
T: +64 3 349 3316
F: +64 3 349 3317
15 Edmonton Road
Hornby, Christchurch 8042

Title **Bottom Plate Detail**

Drawing

RKR-D-41

Scale 1 : 2 @ A4

Date 12.10.2020

1. Scope as per Clauses 1.0 and 9.4 E2/AS1
2. Profiles as per NZS 3617, Branz Bulletin 411 and/or compliance achieved through in-service history, length of service not less than 15 years in all NZ environments B2/VM1 1.1.1 (a)
3. Fixings as per Table 24 E2/AS1
4. Compatibility of materials as per Tables 20-22 E2/AS1
5. Flashing as per Clause 4.0 E2/AS1
6. Rigid and flexible underlay as per Table 23 and Clauses 9.1.5 to 9.1.7 E2/AS1 or proprietary approved alternative
7. All weatherboards to be factory oiled to all faces and weathergrooves prior to installation, ensure maintenance is to manufacturers recommendations
8. The weatherboard system relies on the joinery meeting the requirements of NZS 4211 for the relevant building windzone or wind pressure
9. Timber to NZBC B2 Durability B2.3.1(b), Western Red Cedar, Larch and Truwood®
10. Timber framing to NZS 3604:2011

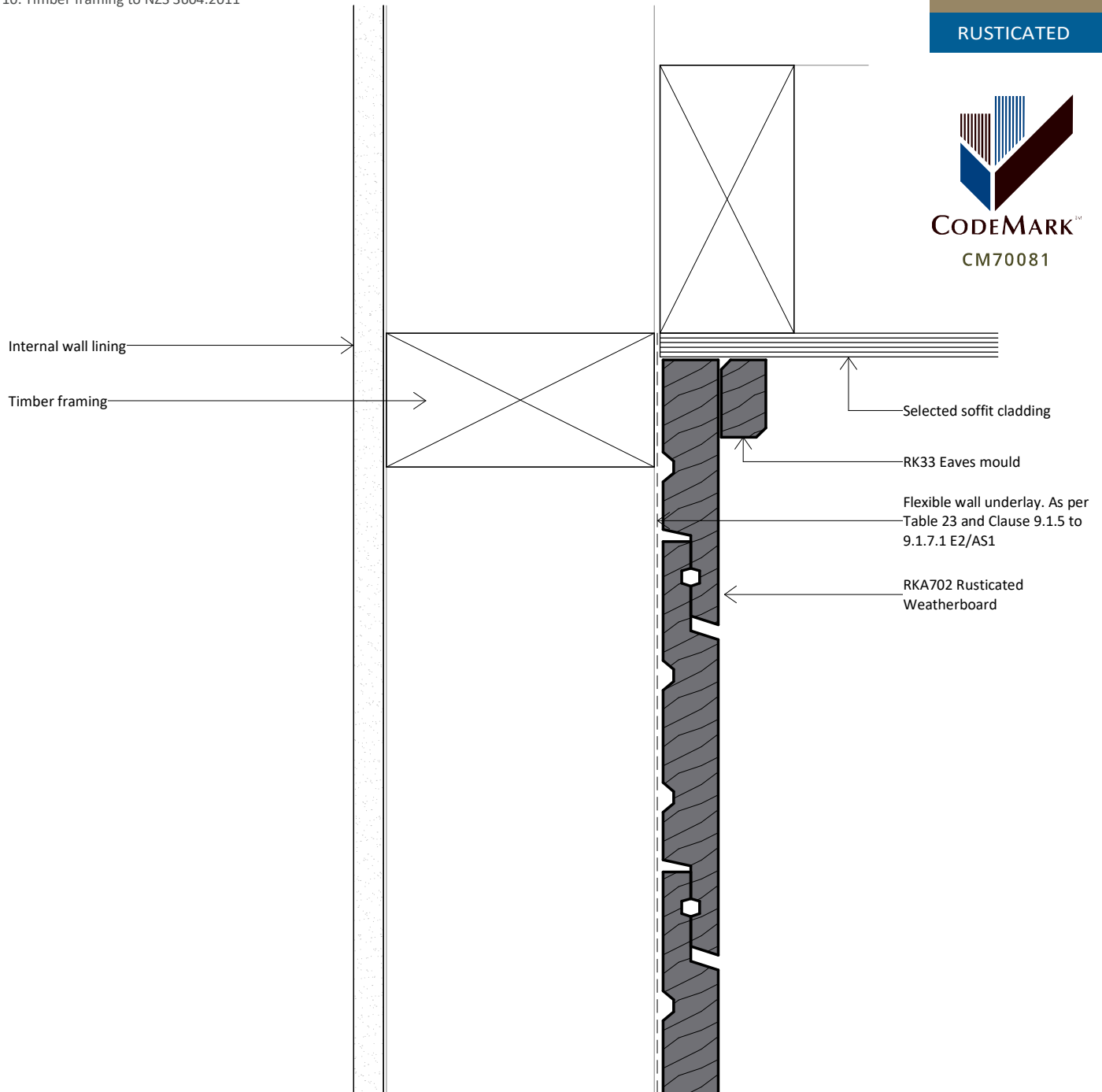

www.rosenfeldkidson.co.nz

Postal address: PO Box 621,
Shortland Street, Auckland 1140

Auckland Branch:
 T: +64 9 573 0503
 F: +64 9 573 0504
 513 Mt Wellington Highway
 Mt Wellington, Auckland 1060

Christchurch Branch:
 T: +64 3 349 3316
 F: +64 3 349 3317
 15 Edmonton Road
 Hornby, Christchurch 8042

Title **Top Plate to Soffit Detail**

Drawing
RKR-D-42

Scale 1 : 2 @ A4 Date 12.10.2020

1. Scope as per Clauses 1.0 and 9.4 E2/AS1
2. Profiles as per NZS 3617, Branz Bulletin 411 and/or compliance achieved through in-service history, length of service not less than 15 years in all NZ environments B2/VM1 1.1.1 (a)
3. Fixings as per Table 24 E2/AS1
4. Compatibility of materials as per Tables 20-22 E2/AS1
5. Flashing as per Clause 4.0 E2/AS1
6. Rigid and flexible underlay as per Table 23 and Clauses 9.1.5 to 9.1.7 E2/AS1 or proprietary approved alternative
7. All weatherboards to be factory oiled to all faces and weathergrooves prior to installation, ensure maintenance is to manufacturers recommendations
8. The weatherboard system relies on the joinery meeting the requirements of NZS 4211 for the relevant building windzone or wind pressure
9. Timber to NZBC B2 Durability B2.3.1(b), Western Red Cedar, Larch and Truwood®
10. Timber framing to NZS 3604:2011

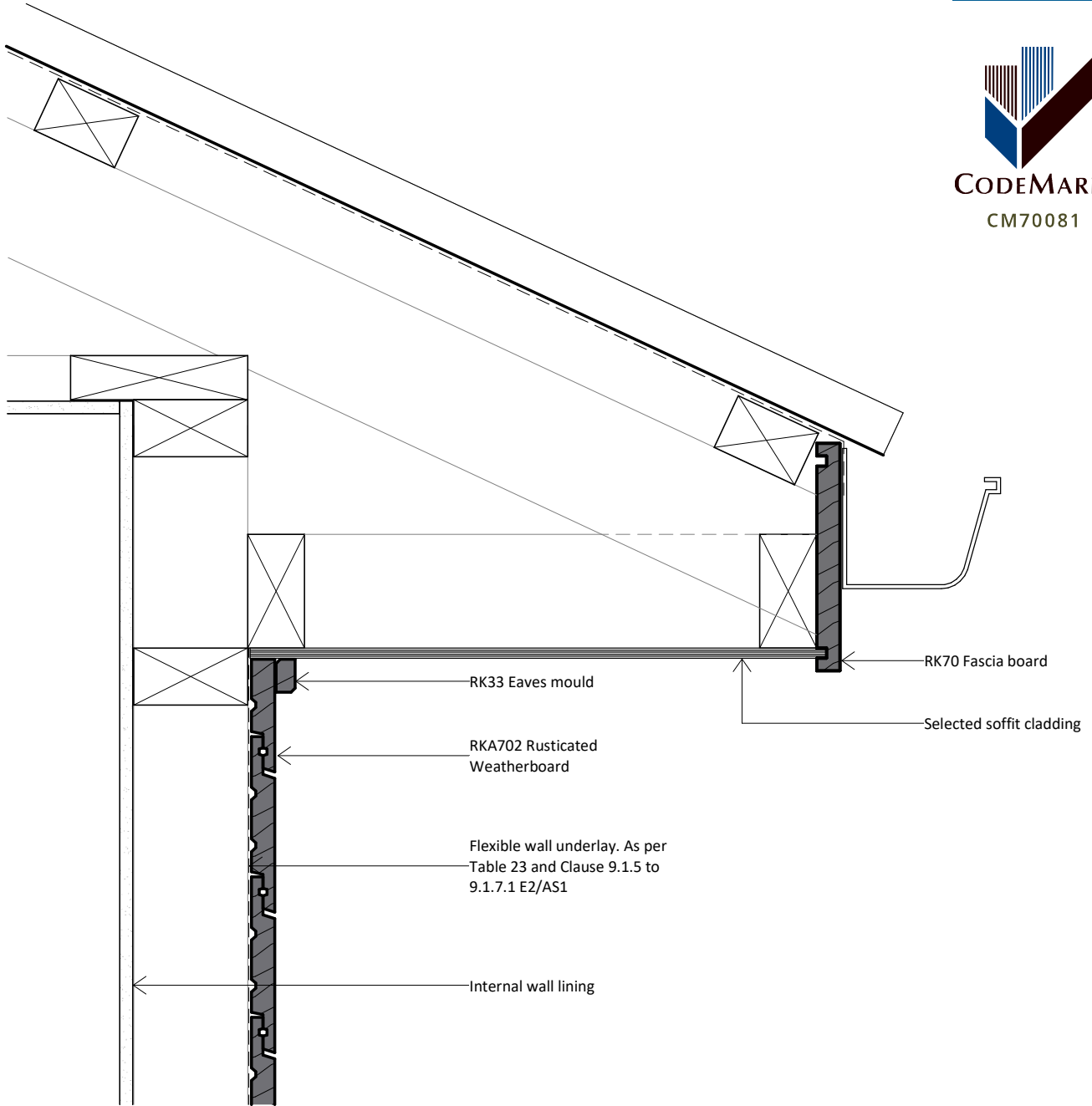

www.rosenfeldkidson.co.nz

Postal address: PO Box 621,
Shortland Street, Auckland 1140

Auckland Branch:

T: +64 9 573 0503
F: +64 9 573 0504
513 Mt Wellington Highway
Mt Wellington, Auckland 1060

Christchurch Branch:

T: +64 3 349 3316
F: +64 3 349 3317
15 Edmonton Road
Hornby, Christchurch 8042

Title **Barge Detail**

Drawing

RKR-D-43

Scale 1 : 5 @ A4

Date 12.10.2020

1. Scope as per Clauses 1.0 and 9.4 E2/AS1
2. Profiles as per NZS 3617, Branz Bulletin 411 and/or compliance achieved through in-service history, length of service not less than 15 years in all NZ environments B2/VM1 1.1.1 (a)
3. Fixings as per Table 24 E2/AS1
4. Compatibility of materials as per Tables 20-22 E2/AS1
5. Flashing as per Clause 4.0 E2/AS1
6. Rigid and flexible underlay as per Table 23 and Clauses 9.1.5 to 9.1.7 E2/AS1 or proprietary approved alternative
7. All weatherboards to be factory oiled to all faces and weathergrooves prior to installation, ensure maintenance is to manufacturers recommendations
8. The weatherboard system relies on the joinery meeting the requirements of NZS 4211 for the relevant building windzone or wind pressure
9. Timber to NZBC B2 Durability B2.3.1(b), Western Red Cedar, Larch and Truwood®
10. Timber framing to NZS 3604:2011

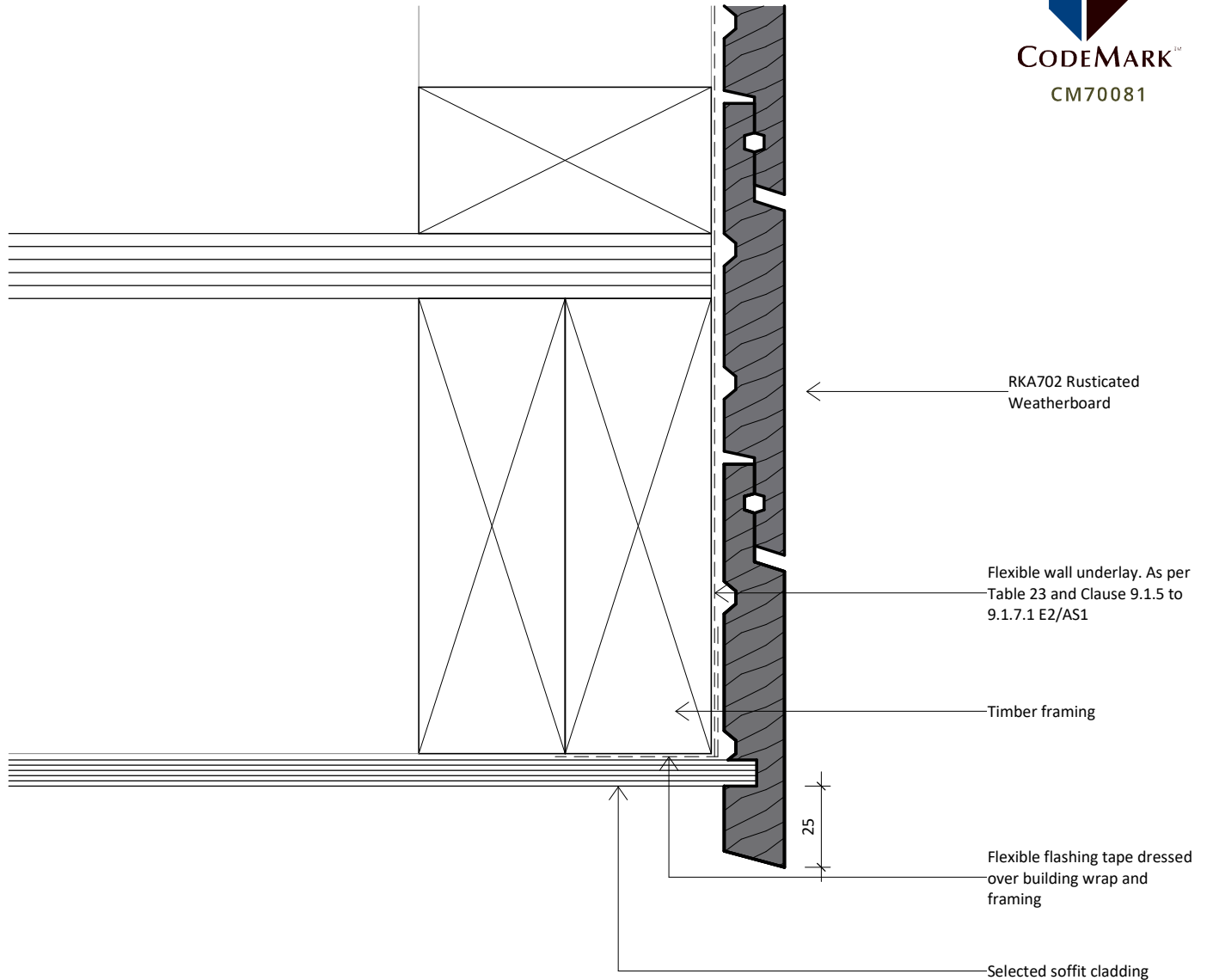

www.rosenfeldkidson.co.nz

Postal address: PO Box 621,
Shortland Street, Auckland 1140

Auckland Branch:
T: +64 9 573 0503
F: +64 9 573 0504
513 Mt Wellington Highway
Mt Wellington, Auckland 1060

Christchurch Branch:
T: +64 3 349 3316
F: +64 3 349 3317
15 Edmonton Road
Hornby, Christchurch 8042

Title **Soffit Detail**

Drawing

RKR-D-44

Scale 1 : 2 @ A4 Date 12.10.2020

1. Scope as per Clauses 1.0 and 9.4 E2/AS1
2. Profiles as per NZS 3617, Branz Bulletin 411 and/or compliance achieved through in-service history, length of service not less than 15 years in all NZ environments B2/VM1 1.1.1 (a)
3. Fixings as per Table 24 E2/AS1
4. Compatibility of materials as per Tables 20-22 E2/AS1
5. Flashing as per Clause 4.0 E2/AS1
6. Rigid and flexible underlay as per Table 23 and Clauses 9.1.5 to 9.1.7 E2/AS1 or proprietary approved alternative
7. All weatherboards to be factory oiled to all faces and weathergrooves prior to installation, ensure maintenance is to manufacturers recommendations
8. The weatherboard system relies on the joinery meeting the requirements of NZS 4211 for the relevant building windzone or wind pressure
9. Timber to NZBC B2 Durability B2.3.1(b), Western Red Cedar, Larch and Truwood®
10. Timber framing to NZS 3604:2011



60 x 3.15 Annular grooved nail. Stainless steel 316 or silicon bronze. Upward slope to fixing

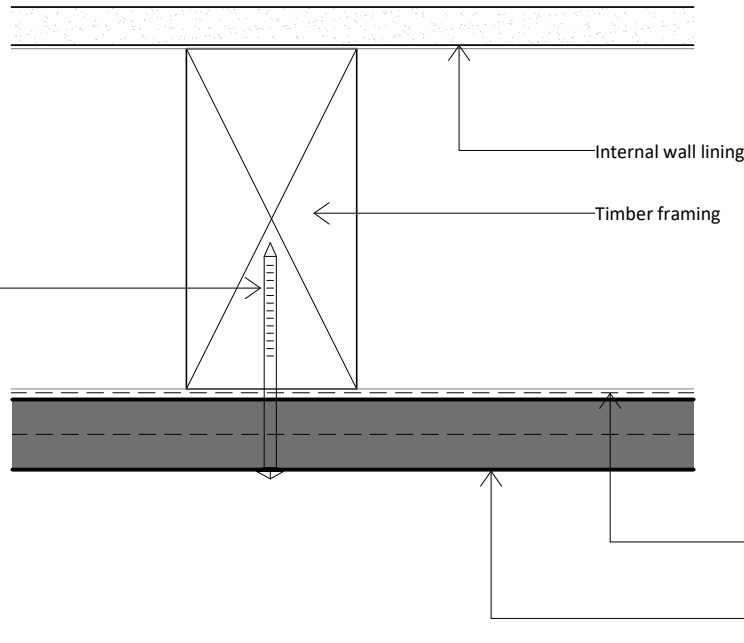

Horizontal fixing

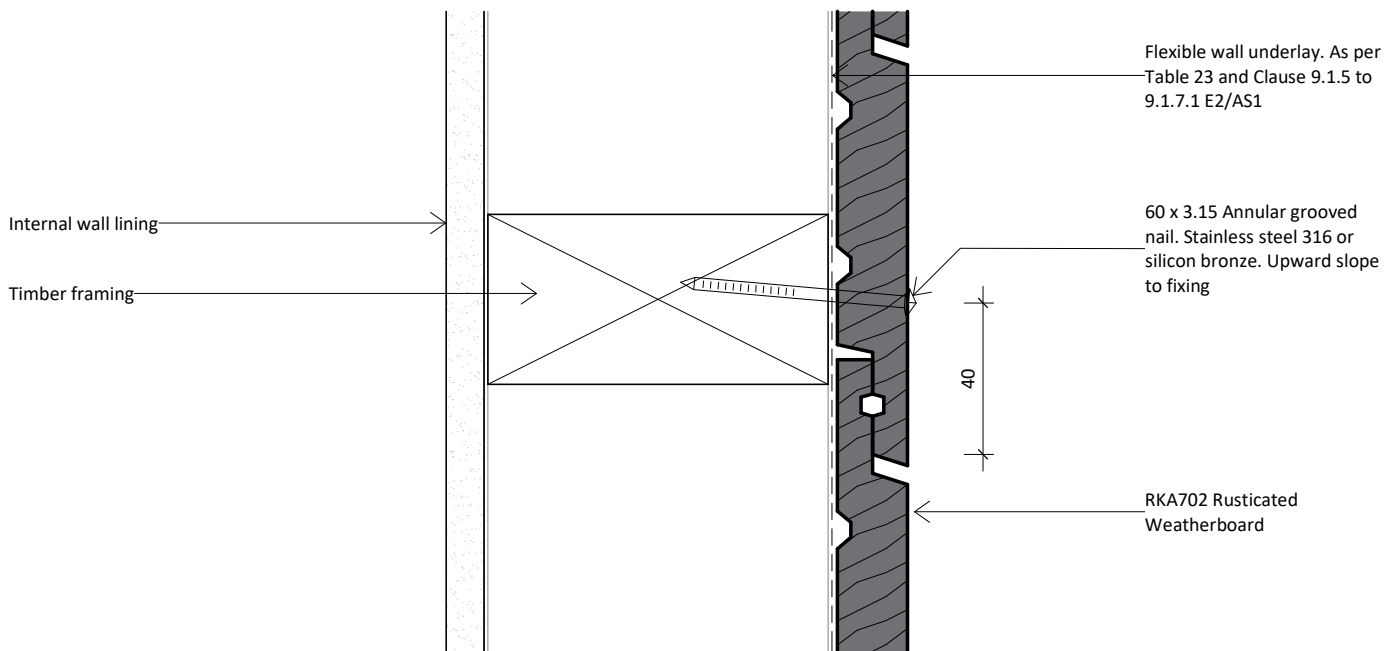

Vertical fixing



www.rosenfeldkidson.co.nz

Postal address: PO Box 621,
Shortland Street, Auckland 1140

Auckland Branch:
T: +64 9 573 0503
F: +64 9 573 0504
513 Mt Wellington Highway
Mt Wellington, Auckland 1060

Christchurch Branch:
T: +64 3 349 3316
F: +64 3 349 3317
15 Edmonton Road
Hornby, Christchurch 8042

Title **Nail Fixing Detail**

Drawing
RKR-D-46

Scale 1 : 2 @ A4 Date 12.10.2020

1. Scope as per Clauses 1.0 and 9.4 E2/AS1
2. Profiles as per NZS 3617, Branz Bulletin 411 and/or compliance achieved through in-service history, length of service not less than 15 years in all NZ environments B2/VM1 1.1.1 (a)
3. Fixings as per Table 24 E2/AS1
4. Compatibility of materials as per Tables 20-22 E2/AS1
5. Flashing as per Clause 4.0 E2/AS1
6. Rigid and flexible underlay as per Table 23 and Clauses 9.1.5 to 9.1.7 E2/AS1 or proprietary approved alternative
7. All weatherboards to be factory oiled to all faces and weathergrooves prior to installation, ensure maintenance is to manufacturers recommendations
8. The weatherboard system relies on the joinery meeting the requirements of NZS 4211 for the relevant building windzone or wind pressure
9. Timber to NZBC B2 Durability B2.3.1(b), Western Red Cedar, Larch and Truwood®
10. Timber framing to NZS 3604:2011



60 x 3.15 Annular grooved nail. Stainless steel 316. To be countersunk 2mm. Fill countersunk nail head with approved filler. Sand and pre-prime prior to finishing coats.

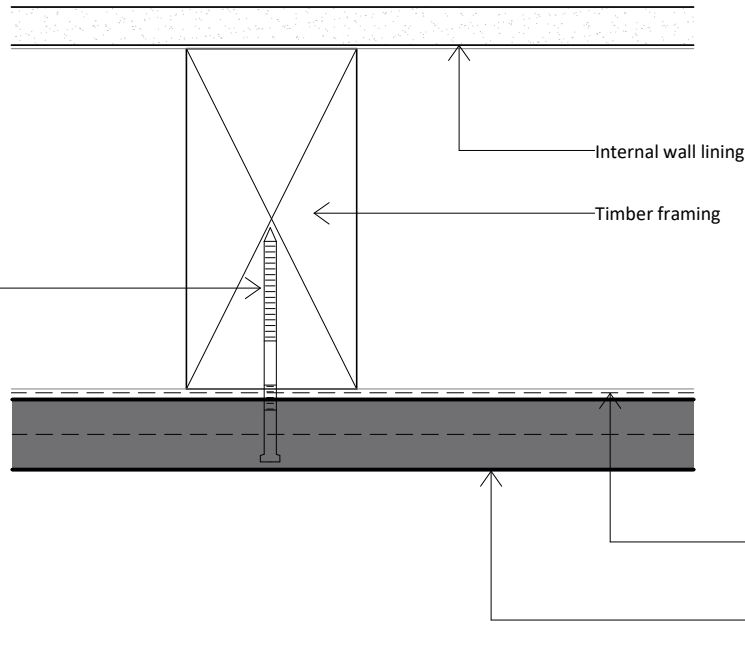

Horizontal fixing

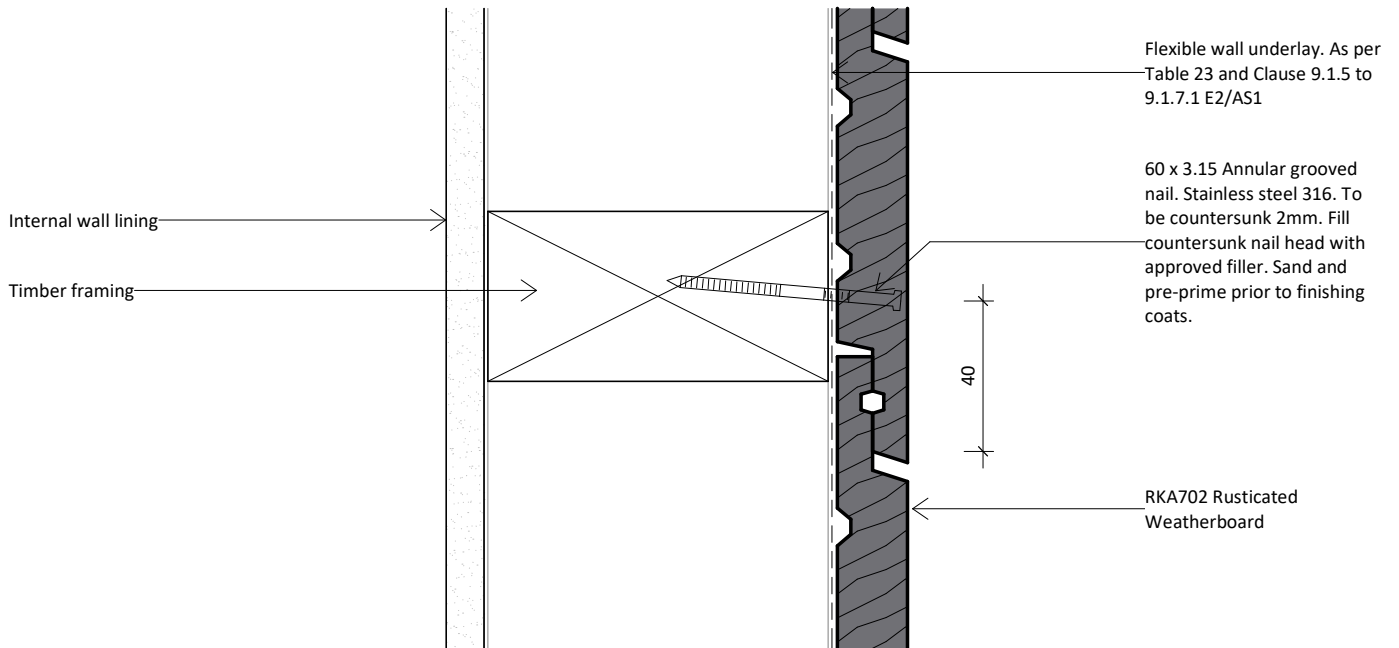

Vertical fixing



www.rosenfeldkidson.co.nz

Postal address: PO Box 621,
Shortland Street, Auckland 1140

Auckland Branch:
T: +64 9 573 0503
F: +64 9 573 0504
513 Mt Wellington Highway
Mt Wellington, Auckland 1060

Christchurch Branch:
T: +64 3 349 3316
F: +64 3 349 3317
15 Edmonton Road
Hornby, Christchurch 8042

Title **Nail Fixing Detail (Paint Finish Only)**

Drawing **RKR-D-47**

Scale 1 : 2 @ A4 Date 12.10.2020